



Ausere hardware



More than 30 years in the Spanish market is what endorses the seriousness of our company and the quality of all of our products. We manufacture according to the European standards of quality, prime materials, security and fire resistance, this is confirmed with the certifications granted to us by international laboratories, both European and Spanish.

We are manufactures not intermediaries.

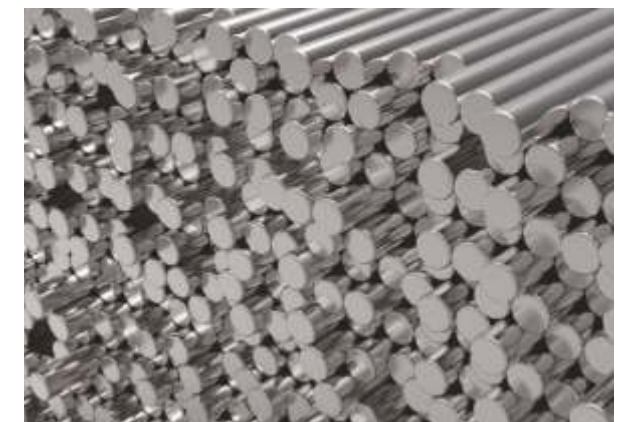

Quality
Quality
Quality



Spain
Spain
Spain



Certificate of Constancy of Performance

0359-CPR-000541

Intertek

In compliance with Regulation 305/2011/EU of the European Parliament and of the Council of 9 March 2011 (the Construction Products Regulation), this certificate applies to the construction product(s).

Product(s): Mechanically operated locks, latches and locking plates
(refer to attached appendix for details and conditions)

Placed on the market under the trade mark of: HERRAJES AUSERE SL
Malpica Alfinden Industrial Estate P Street, Industrial Unit 5, 50171, La Puebla de Alfinden, Zaragoza, Spain.

Produced in the manufacturing plant(s): HERRAJES AUSERE SL

Intended use: When used with an appropriate door closing device on fire and/or smoke control doors to fulfil the self-closing requirement of such doors, and thereafter to ensure that the door remains shut.
This certificate attests that all provisions concerning the assessment and verification of constancy of performance described in Annex ZA of the standard(s):

EN 12209:2003/AC:2005

Under system 1 for the performance set out in this certificate are applied and that the performance of the construction product is assessed to remain constant.

This certificate was first issued on 6th December 2017 under CPR (305/2011) and will remain valid as long as neither the harmonised standard, the construction product, the AVCP methods nor the manufacturing conditions in the plant are modified significantly, unless suspended or withdrawn by the notified product certification body.

The issued document and statement(s) herein makes reference only to a presumption of conformity in accordance with the CPR Regulations EU 305/2011 (as amended). However, it is the manufacturer's or their authorised representative's sole responsibility to affix the CE logo and, by doing so, confirms full compliance and conformity to all other European mandatory directives and regulations that may also apply.



0359

Intertek Testing & Certification Limited
Cleeve Road, Leatherhead
Surrey, KT22 7SB
Tel: +44 (0)1372 370900
Fax: +44 (0)1372 370977
E-mail: cpd.uk@intertek.com

D. Bigland

David Bigland

Date: 6 Dec-2017
Issue: 01

Certification Manager

www.intertek.com

Registered No 3272281, Academy Place, 1-9 Brook Street, Brentwood, Essex, CM14 5NQ, United Kingdom

This Certificate is for the exclusive use of Intertek's client and is provided pursuant to the agreement between Intertek and its Client. Intertek's responsibility and liability are limited to the terms and conditions of the agreement. Intertek assumes no liability to any party, other than to the Client in accordance with the agreement, for any loss, expense or damage occasioned by the use of this Certificate. Only the Client is authorized to permit copying or distribution of this Certificate and then only in its entirety. Any use of the Intertek name or one of its marks for the sale or advertisement of the tested material, product or service must first be approved in writing by Intertek.

Intertek



REPORT NUMBER:160913003SHF-BP-2
ORIGINAL ISSUE DATE: August 11, 2017

EVALUATION CENTER

Intertek Testing Services Ltd.,

RENDERED TO

HERRAJES AUSERE SL
Malpica Alfinden Industrial Estate
P Street, industrial unit 5
50171 La Puebla de Alfinden (Zaragoza – Spain)

PRODUCT EVALUATED

Mortise lock
Model: 10800

EVALUATION PROPERTY

Fire Resistance

TEST REPORT

Report of Testing Mortise lock – Model of 10800 in Single Leaf Single Action Steel Fire Door for compliance with the applicable requirements of the following criteria: EN 1634-1:2014, Fire resistance and smoke control tests for door and shutter assemblies, openable windows and elements of building hardware – Part 1: Fire resistance test for door and shutter assemblies and openable windows.

"This report is for the exclusive use of Intertek's Client and is provided pursuant to the agreement between Intertek and its Client. Intertek's responsibility and liability are limited to the terms and conditions of the agreement. Intertek assumes no liability to any party, other than to the Client in accordance with the agreement, for any loss, expense or damage occasioned by the use of this report. Only the Client is authorized to permit copying or distribution of this report and then only in its entirety. Any use of the Intertek name or one of its marks for the sale or advertisement of the tested material, product or service must first be approved in writing by Intertek. The observations and test results in this report are relevant only to the sample tested. This report by itself does not imply that the material, product, or service is or has ever been under an Intertek certification program."

Certificate of Constancy of Performance

0359-CPR-000541

Intertek

In compliance with Regulation 305/2011/EU of the European Parliament and of the Council of 9 March 2011 (the Construction Products Regulation), this certificate applies to the construction product(s).

Product(s): Mechanically operated locks, latches and locking plates
(refer to attached appendix for details and conditions)

Placed on the market under the trade mark of: HERRAJES AUSERE SL
Malpica Alfinden Industrial Estate P Street, Industrial Unit 5, 50171, La Puebla de Alfinden, Zaragoza, Spain.

Produced in the manufacturing plant(s): HERRAJES AUSERE SL

Intended use: When used with an appropriate door closing device on fire and/or smoke control doors to fulfil the self-closing requirement of such doors, and thereafter to ensure that the door remains shut.
This certificate attests that all provisions concerning the assessment and verification of constancy of performance described in Annex ZA of the standard(s):

EN 12209:2003/AC:2005

Under system 1 for the performance set out in this certificate are applied and that the performance of the construction product is assessed to remain constant.

This certificate was first issued on 6th December 2017 under CPR (305/2011) and will remain valid as long as neither the harmonised standard, the construction product, the AVCP methods nor the manufacturing conditions in the plant are modified significantly, unless suspended or withdrawn by the notified product certification body.

The issued document and statement(s) herein makes reference only to a presumption of conformity in accordance with the CPR Regulations EU 305/2011 (as amended). However, it is the manufacturer's or their authorised representative's sole responsibility to affix the CE logo and, by doing so, confirms full compliance and conformity to all other European mandatory directives and regulations that may also apply.



0359

Intertek Testing & Certification Limited
Cleeve Road, Leatherhead
Surrey, KT22 7SB
Tel: +44 (0)1372 370900
Fax: +44 (0)1372 370977
E-mail: cpd.uk@intertek.com

D. Bigland

David Bigland

Date: 6 Dec-2017
Issue: 01

Certification Manager

www.intertek.com

Registered No 3272281, Academy Place, 1-9 Brook Street, Brentwood, Essex, CM14 5NQ, United Kingdom

This Certificate is for the exclusive use of Intertek's client and is provided pursuant to the agreement between Intertek and its Client. Intertek's responsibility and liability are limited to the terms and conditions of the agreement. Intertek assumes no liability to any party, other than to the Client in accordance with the agreement, for any loss, expense or damage occasioned by the use of this Certificate. Only the Client is authorized to permit copying or distribution of this Certificate and then only in its entirety. Any use of the Intertek name or one of its marks for the sale or advertisement of the tested material, product or service must first be approved in writing by Intertek.

Intertek



REPORT NUMBER:160913003SHF-BP-2
ORIGINAL ISSUE DATE: August 11, 2017

EVALUATION CENTER

Intertek Testing Services Ltd.,

RENDERED TO

HERRAJES AUSERE SL
Malpica Alfinden Industrial Estate
P Street, industrial unit 5
50171 La Puebla de Alfinden (Zaragoza – Spain)

PRODUCT EVALUATED

Mortise lock
Model: 10800

EVALUATION PROPERTY

Fire Resistance

TEST REPORT

Report of Testing Mortise lock – Model of 10800 in Single Leaf Single Action Steel Fire Door for compliance with the applicable requirements of the following criteria: EN 1634-1:2014, Fire resistance and smoke control tests for door and shutter assemblies, openable windows and elements of building hardware – Part 1: Fire resistance test for door and shutter assemblies and openable windows.

"This report is for the exclusive use of Intertek's Client and is provided pursuant to the agreement between Intertek and its Client. Intertek's responsibility and liability are limited to the terms and conditions of the agreement. Intertek assumes no liability to any party, other than to the Client in accordance with the agreement, for any loss, expense or damage occasioned by the use of this report. Only the Client is authorized to permit copying or distribution of this report and then only in its entirety. Any use of the Intertek name or one of its marks for the sale or advertisement of the tested material, product or service must first be approved in writing by Intertek. The observations and test results in this report are relevant only to the sample tested. This report by itself does not imply that the material, product, or service is or has ever been under an Intertek certification program."

REPORT NUMBER: 160913003SHF-BP-3
ORIGINAL ISSUE DATE: August 12, 2017

EVALUATION CENTER

Intertek Testing Services Ltd.,

RENDERED TO

HERRAJES AUSERE SL
Malpica Alfinden Industrial Estate
P Street, industrial unit 5
50171 La Puebla de Alfinden (Zaragoza – Spain)

PRODUCT EVALUATED
DOOR HANDLE
Model: 8400

EVALUATION PROPERTY
Fire Resistance

Report of Testing DOOR HANDLE – Model of 8400 in Single Leaf Single Action Steel Fire Door for compliance with the applicable requirements of the following criteria: EN 1634-1:2014, Fire resistance and smoke control tests for door and shutter assemblies, openable windows and elements of building hardware – Part 1: Fire resistance test for door and shutter assemblies and openable windows.

"This report is for the exclusive use of Intertek's Client and is provided pursuant to the agreement between Intertek and its Client. Intertek's responsibility and liability are limited to the terms and conditions of the agreement. Intertek assumes no liability to any party, other than to the Client in accordance with the agreement, for any loss, expense or damage occasioned by the use of this report. Only the Client is authorized to permit copying or distribution of this report and then only in its entirety. Any use of the Intertek name or one of its marks for the sale or advertisement of the tested material, product or service must first be approved in writing by Intertek. The observations and test results in this report are relevant only to the sample tested. This report by itself does not imply that the material, product, or service is or has ever been under an Intertek certification program."

Test Verification of Conformity

In the basis of the tests undertaken, the sample(s) of the below product have been found to comply with the requirements of the referenced specifications at the time the tests were carried out. This verification is part of the full test report(s) and should be read in conjunction with them.

Applicant Name & Address: HERRAJES AUSERE SL
Malpica Alfinden Industrial Estate P Street, industrial unit 550171 La Pueb
Alfinden (Zaragoza – Spain)

Product Description: Door handle

Ratings & Principle Characteristics:

4	7	–	B	1	4	0	B
---	---	---	---	---	---	---	---

Models: 8400

Brand Name: HERRAJES AUSERE SL

Relevant Standards: EN 1906:2012 Building hardware –Lever handles and knob furniture – Requirements and test methods

Verification Issuing Office Name & Address: Intertek Testing Services Shenzhen Ltd. Guangzhou Branch.
No. 9 Nan Xiang San Road, GETDD, Guangzhou, China.

Date of Tests: September 5, 2016 to October 27, 2016

Test Report Number(s): 160909087GZU-001 & 160913003SHF-BP-3

Jodie Zhou

Signature

Name: Jodie Zhou
Position: Technical Manager
Date: November 16, 2017

This Verification is for the exclusive use of Intertek's client and is provided pursuant to the agreement between Intertek and its Client. Intertek's responsibility and liability are limited to the terms and conditions of the agreement. Intertek assumes no liability to any party, other than to the Client in accordance with the agreement, for any loss, expense or damage occasioned by the use of this Verification. Only the Client is authorized to permit copying or distribution of this Verification. Any use of the Intertek name or one of its marks for the sale or advertisement of the tested material, product or service must first be approved in writing by Intertek. The observations and test/inspection results referenced in this Verification are relevant only to the sample tested/inspected. This Verification by itself does not imply that the material, product, or service is or has ever been under an Intertek certification program.



CERTIFICATE OF CONFORMITY

Certificate No.: CNT1601061001-3

The Certification Body of

CANEW TESTING AND CERTIFICATION LTD

Certifies that

Applicant: HERRAJES AUSERE SL.

Address: Poligono Malpica – Alfinden calle P nave 5 50171 La Puebla de Alfinden Zaragoza Spain

Product: Stainless steel door handle

Rating (S)

3	7	-	1	1	4	0	B
---	---	---	---	---	---	---	---

Type: 8400.8200.8900

Complies with the requirements of the European Community **Electromagnetic Compatibility (CPD/CPR) Regulation (EU) No 305/2011**. The submitted products have been tested by us and found in compliance with the following European Standards:
EN 1906-2012

This certificate of conformity is based on an evaluation of a sample of the above mentioned product. It does not imply an assessment of the whole production. This certificate should be used in conjunction with the technical documentation file related to the product.



Signature:

Timothy Walsh

Date of issue: Nov 20, 2017



CANEW TESTING AND CERTIFICATION LTD

30 IRONMONGERS PLACE, LONDON, ENGLAND E14 9YD .Company No. 08936663



CERTIFICATE OF CONFORMITY

Certificate No.: CNT1601061001-2

The Certification Body of

CANEW TESTING AND CERTIFICATION LTD

Certifies that

Applicant: HERRAJES AUSERE SL.

Address: Poligono Malpica – Alfinden calle P nave 5 50171 La Puebla de Alfinden Zaragoza Spain

Product: Stainless steel lock body

Rating (s)

3	M	8	1	0	C	1	B	A	2	0
---	---	---	---	---	---	---	---	---	---	---

Type: 10800

Complies with the requirements of the European Community **Electromagnetic Compatibility (CPD/CPR) Regulation (EU) No 305/2011**. The submitted products have been tested by us and found in compliance with the following European Standards:
EN 12209-2003

This certificate of conformity is based on an evaluation of a sample of the above mentioned product. It does not imply an assessment of the whole production. This certificate should be used in conjunction with the technical documentation file related to the product.



Signature:

Timothy Walsh

Date of issue: Jan 20, 2017



CANEW TESTING AND CERTIFICATION LTD

30 IRONMONGERS PLACE, LONDON, ENGLAND E14 9YD .Company No. 08936663

APPLICANT **HERRAJES AUSERÉ**
Rafael Auseré
Pol. Ind. Malpica-Alfindén, C/P nave 5
50171 La Puebla de Alfindén
Zaragoza (España)

Test Results

Two visual inspections have been performed:

- First inspection: after 240 hours.
- Final inspection: after 480 hours.

These periods correspond to different levels of resistance to corrosion of the building hardware and they are specified at the standard UNE-EN 1670:2007: "Building hardware. Corrosion resistance. Requirements and test methods".

Grade	Hours of test	Product classification	Terms of use
4	240 hours	High corrosion resistance	Outdoor use in very hard conditions
5	480 hours	Exceptionally high corrosion resistance	Outdoor use in exceptionally severe conditions

Before each inspection, the samples were rinsed with tap water and dried with air.

Revision after 240 hours test

ITA Identification	Petitioner Identification	Grade of corrosion	Grade 4
C/100739/3	AISI 304 Series 3000 AISI 304 Series 8000	Not observed	OK
C/100739/4	HERRAJES AUSERÉ	Not observed	OK

Revision after 480 hours test

ITA Identification	Petitioner Identification	Grade of corrosion	Grade 5
C/100739/1	AISI 316 Series 3000 AISI 316 Series 8000	Not observed	OK
C/100739/7	HERRAJES AUSERÉ	Not observed	OK

BLANCA ROBLES SIMON, HEAD OF THE CUSTOMER SERVICE OF THE OFFICIAL CHAMBER OF COMMERCE, INDUSTRY AND SERVICES OF ZARAGOZA

HEREBY CERTIFIES:

1.- That the company **HERRAJES AUSERÉ S.L.**, whose VAT number is B99036766, domiciled in MALPICA- ALFINDEN CALLE P5 – 50017 LA PUEBLA DE ALFINDEN (ZARAGOZA), appears in the public census of this Chamber of Commerce, Industry and Services as such company, being registered in the Spanish Tax on Commercial and Professional Activities and Companies, in the epigraphs: 316.2 "Manufacture of hardware and locksmith goods", and 615.3 "Wholesale trade in electrical appliances and hardware".

2.- That the above mentioned company submits to this Chamber a certificate dated twenty-seventh of April two thousand eighteen, issued by Mr. Rafael Auseré Alijarde, in his capacity as Manager of the company, according to which this company is legally incorporated and the above mentioned epigraphs enable them to manufacture and commercialize the following products:

- Cubicle Partitions Hardware
- Door Handles – Pull Handles – Accessories
- Locks
- Cylinders
- Hinges
- Door Closers
- Panic Devices

Lastly, it is recorded in the said certificate that these products are on free sale, distribution and consumption in Spain.

And for the record, where appropriate, at the request of the interested party, and in order to be of legal effect in the **KINGDOM OF SAUDI ARABIA**, I issue this certificate in Zaragoza, on the thirtieth of April two thousand eighteen.

[Signature]
CÁMARA OFICIAL DE COMERCIO, INDUSTRIA Y SERVICIOS DE ZARAGOZA

ATC/MJF



GA-2008/0293

ER-1577/2001

BLANCA ROBLES SIMON, HEAD OF THE CUSTOMER SERVICE OF THE OFFICIAL CHAMBER OF COMMERCE,INDUSTRY AND SERVICES OF ZARAGOZA

HEREBY CERTIFIES: That the company **HERRAJES AUSERE S.L.**, with Tax number B99036766, domiciled in MALPICA-ALFINDEN CALLE P5 – 50017 LA PUEBLA DE ALFINDEN (ZARAGOZA), appears in the public census of this Chamber of Commerce, Industry and Services as such company, being registered in the Spanish Tax on Commercial and Professional Activities and Companies, in the epigraphs. 316.2 “*Manufacture of hardware and locksmith goods*”, and 615.3 “*Wholesale trade in electrical appliances and hardware*”, not being known to this Corporation any data contrary to its capacity to contract.

And for the record, where appropriate, at the request of the interested party, and in order to be of legal effect, I issue this certificate in Zaragoza, on the thirtieth of April two thousand eighteen.



ATC/mjf

Tubular lever handles / Solid lever handles / 8400 series



Tubular lever handles
Stainless steel AISI 304 - AISI 316

Ausere Hardware *Spain*



Model code 8401

Tubular lever handle set with keyholes all made of stainless steel complying all to the international specifications of quality. Double plates on rosette. Interior rosette for installations on stainless steel. Exterior rosette for embellishing of stainless steel. Installation through screws of stainless steel that are included. 8 mm spindle of treated iron. Recovery of handle through treated spring of very high quality. Screws and allen key included individual packing per set. Finishes: SSS – PSS – PVD.

Manufactured according to the requirements of the standard EN 1906:2012.

Fire resistance 132 min. 200.000 cycles.

4	7	-	B	1	4	0	B
---	---	---	---	---	---	---	---

Code model for other plates

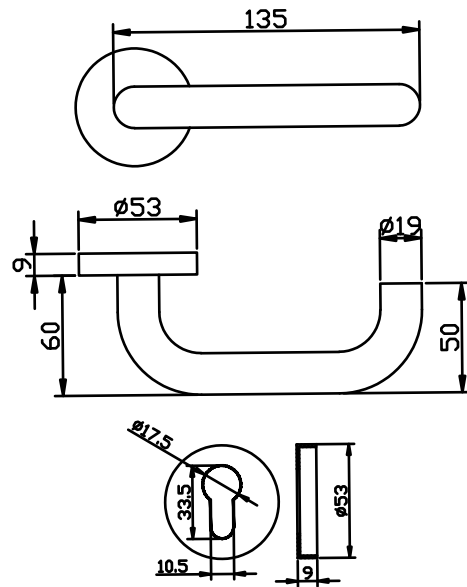
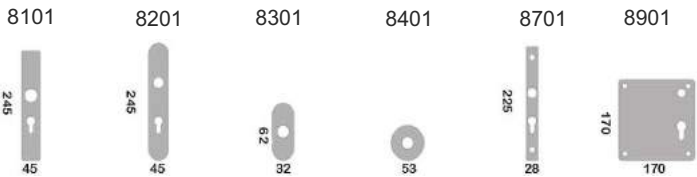

HERRAJES AUSERE - Catalog

Ausere Hardware *Spain*

Tubular lever handles
Stainless steel AISI 304 - AISI 316



Model code 8402

Tubular lever handle set with keyholes all made of stainless steel complying all to the international specifications of quality. Double plates on rosette. Interior rosette for installations on stainless steel. Exterior rosette for embellishing of stainless steel. Installation through screws of stainless steel that are included. 8 mm spindle of treated iron. Recovery of handle through treated spring of very high quality. Screws and allen key included individual packing per set. Finishes: SSS – PSS – PVD.

Manufactured according to the requirements of the standard EN 1906:2012.

Fire resistance 132 min. 200.000 cycles.

4	7	-	B	1	4	0	B
---	---	---	---	---	---	---	---

Code model for other plates

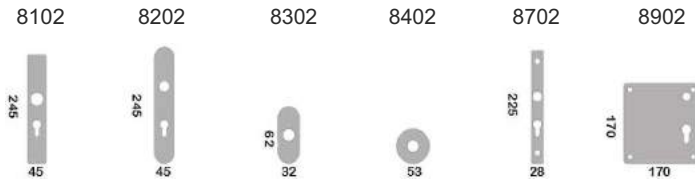

HERRAJES AUSERE - Catalog

Tubular lever handles
Stainless steel AISI 304 - AISI 316

Ausere Hardware *Spain*







Model code 8403

Tubular lever handle set with keyholes all made of stainless steel complying all to the international specifications of quality. Double plates on rosette. Interior rosette for installations on stainless steel. Exterior rosette for embellishing of stainless steel. Installation through screws of stainless steel that are included. 8 mm spindle of treated iron. Recovery of handle through treated spring of very high quality. Screws and allen key included individual packing per set. Finishes: SSS – PSS – PVD.

Manufactured according to the requirements of the standard EN 1906:2012.
Fire resistance 132 min. 200.000 cycles.

4	7	-	B	1	4	0	B
---	---	---	---	---	---	---	---

Code model for other plates

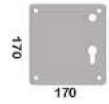
8103	8203	8303	8403	8703	8903
					
245	245	62	53	225	170
45	45	32		28	170

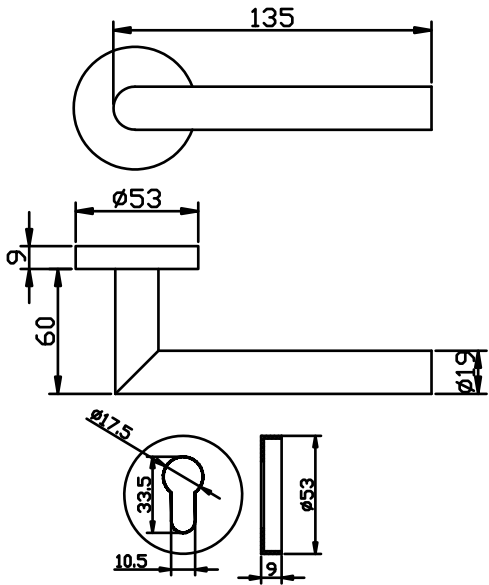

HERRAJES AUSERE - Catalog

Ausere Hardware *Spain*

Tubular lever handles
Stainless steel AISI 304 - AISI 316







Model code 8404

Tubular lever handle set with keyholes all made of stainless steel complying all to the international specifications of quality. Double plates on rosette. Interior rosette for installations on stainless steel. Exterior rosette for embellishing of stainless steel. Installation through screws of stainless steel that are included. 8 mm spindle of treated iron. Recovery of handle through treated spring of very high quality. Screws and allen key included individual packing per set. Finishes: SSS – PSS – PVD.

Manufactured according to the requirements of the standard EN 1906:2012.
Fire resistance 132 min. 200.000 cycles.

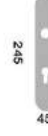
4	7	-	B	1	4	0	B
---	---	---	---	---	---	---	---

Code model for other plates

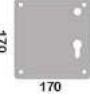
8104	8204	8304	8404	8704	8904
					
245	245	62	53	225	170
45	45	32		28	170

HERRAJES AUSERE - Catalog

Tubular lever handles
Stainless steel AISI 304 - AISI 316

Ausere Hardware *Spain*



Model code 8405

Tubular lever handle set with keyholes all made of stainless steel complying all to the international specifications of quality. Double plates on rosette. Interior rosette for installations on stainless steel. Exterior rosette for embellishing of stainless steel. Installation through screws of stainless steel that are included. 8 mm spindle of treated iron. Recovery of handle through treated spring of very high quality. Screws and allen key included individual packing per set. Finishes: SSS – PSS – PVD.

Manufactured according to the requirements of the standard EN 1906:2012.
Fire resistance 132 min. 200.000 cycles.

4	7	-	B	1	4	0	B
---	---	---	---	---	---	---	---

Code model for other plates

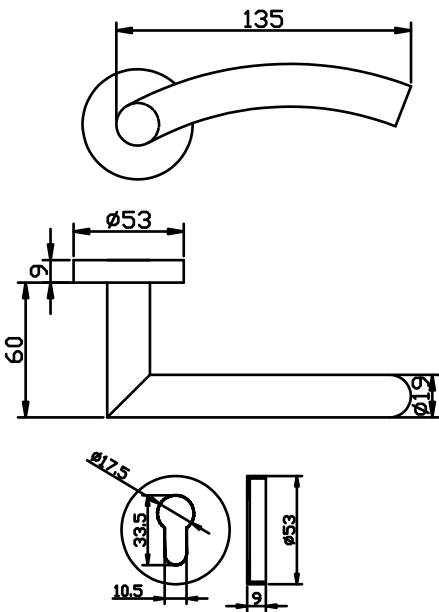
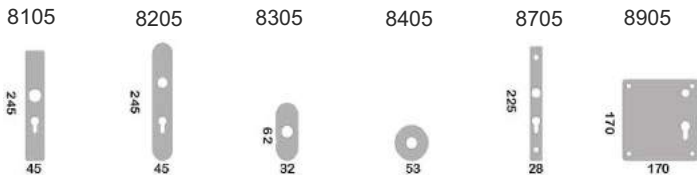

HERRAJES AUSERE - Catalog

Ausere Hardware *Spain*

Tubular lever handles
Stainless steel AISI 304 - AISI 316



Model code 8406

Tubular lever handle set with keyholes all made of stainless steel complying all to the international specifications of quality. Double plates on rosette. Interior rosette for installations on stainless steel. Exterior rosette for embellishing of stainless steel. Installation through screws of stainless steel that are included. 8 mm spindle of treated iron. Recovery of handle through treated spring of very high quality. Screws and allen key included individual packing per set. Finishes: SSS – PSS – PVD.

Manufactured according to the requirements of the standard EN 1906:2012.
Fire resistance 132 min. 200.000 cycles.

4	7	-	B	1	4	0	B
---	---	---	---	---	---	---	---

Code model for other plates

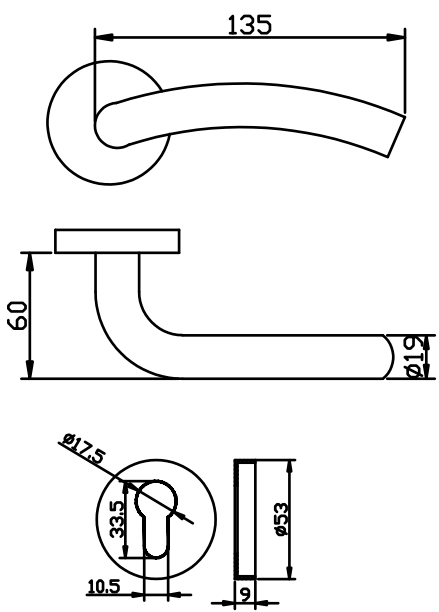

HERRAJES AUSERE - Catalog

Tubular lever handles
Stainless steel AISI 304 - AISI 316

Ausere Hardware *Spain*



Model code 8407

Tubular lever handle set with keyholes all made of stainless steel complying all to the international specifications of quality. Double plates on rosette. Interior rosette for installations on stainless steel. Exterior rosette for embellishing of stainless steel. Installation through screws of stainless steel that are included. 8 mm spindle of treated iron. Recovery of handle through treated spring of very high quality. Screws and allen key included individual packing per set. Finishes: SSS – PSS – PVD.

Manufactured according to the requirements of the standard EN 1906:2012.
Fire resistance 132 min. 200.000 cycles.

4	7	-	B	1	4	0	B
---	---	---	---	---	---	---	---

Code model for other plates

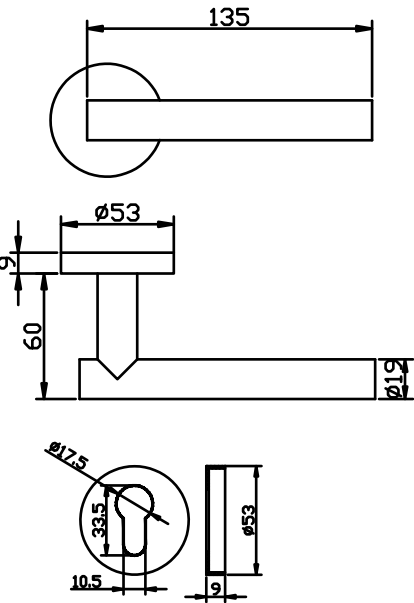
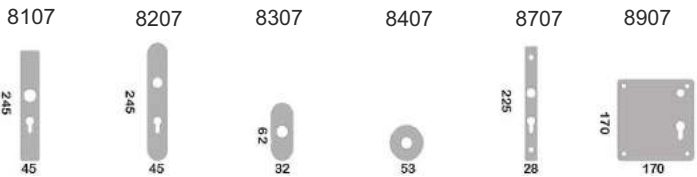

HERRAJES AUSERE - Catalog

Ausere Hardware *Spain*

Tubular lever handles
Stainless steel AISI 304 - AISI 316



Model code 8408

Tubular lever handle set with keyholes all made of stainless steel complying all to the international specifications of quality. Double plates on rosette. Interior rosette for installations on stainless steel. Exterior rosette for embellishing of stainless steel. Installation through screws of stainless steel that are included. 8 mm spindle of treated iron. Recovery of handle through treated spring of very high quality. Screws and allen key included individual packing per set. Finishes: SSS – PSS – PVD.

Manufactured according to the requirements of the standard EN 1906:2012.
Fire resistance 132 min. 200.000 cycles.

4	7	-	B	1	4	0	B
---	---	---	---	---	---	---	---

Code model for other plates



HERRAJES AUSERE - Catalog

Tubular lever handles
Stainless steel AISI 304 - AISI 316

Ausere Hardware *Spain*



Model code 8409

Tubular lever handle set with keyholes all made of stainless steel complying all to the international specifications of quality. Double plates on rosette. Interior rosette for installations on stainless steel. Exterior rosette for embellishing of stainless steel. Installation through screws of stainless steel that are included. 8 mm spindle of treated iron. Recovery of handle through treated spring of very high quality. Screws and allen key included individual packing per set. Finishes: SSS – PSS – PVD.

Manufactured according to the requirements of the standard EN 1906:2012.
Fire resistance 132 min. 200.000 cycles.

4	7	-	B	1	4	0	B
---	---	---	---	---	---	---	---

Code model for other plates

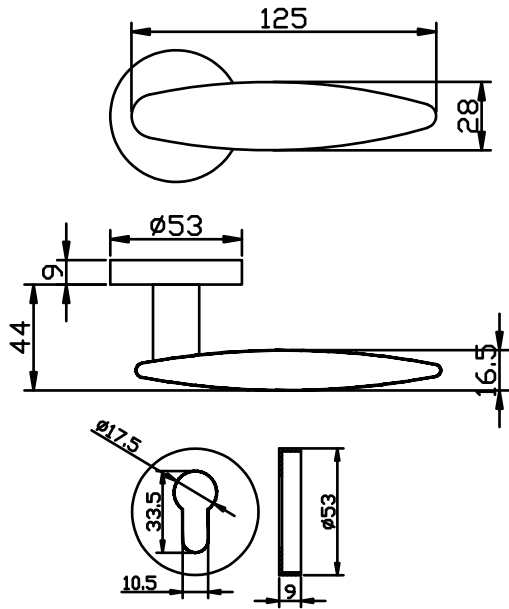
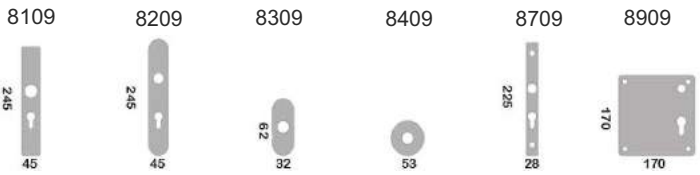

HERRAJES AUSERE - Catalog

Ausere Hardware *Spain*

Tubular lever handles
Stainless steel AISI 304 - AISI 316



Model code 8410

Tubular lever handle set with keyholes all made of stainless steel complying all to the international specifications of quality. Double plates on rosette. Interior rosette for installations on stainless steel. Exterior rosette for embellishing of stainless steel. Installation through screws of stainless steel that are included. 8 mm spindle of treated iron. Recovery of handle through treated spring of very high quality. Screws and allen key included individual packing per set. Finishes: SSS – PSS – PVD.

Manufactured according to the requirements of the standard EN 1906:2012.
Fire resistance 132 min. 200.000 cycles.

4	7	-	B	1	4	0	B
---	---	---	---	---	---	---	---

Code model for other plates

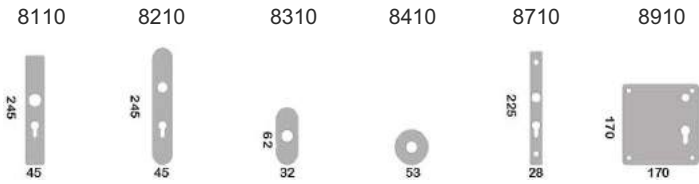

HERRAJES AUSERE - Catalog

Tubular lever handles
Stainless steel AISI 304 - AISI 316

Ausere Hardware *Spain*



Model code 8411

Tubular lever handle set with keyholes all made of stainless steel complying all to the international specifications of quality. Double plates on rosette. Interior rosette for installations on stainless steel. Exterior rosette for embellishing of stainless steel. Installation through screws of stainless steel that are included. 8 mm spindle of treated iron. Recovery of handle through treated spring of very high quality. Screws and allen key included individual packing per set. Finishes: SSS – PSS – PVD.

Manufactured according to the requirements of the standard EN 1906:2012.
Fire resistance 132 min. 200.000 cycles.

4	7	-	B	1	4	0	B
---	---	---	---	---	---	---	---

Code model for other plates

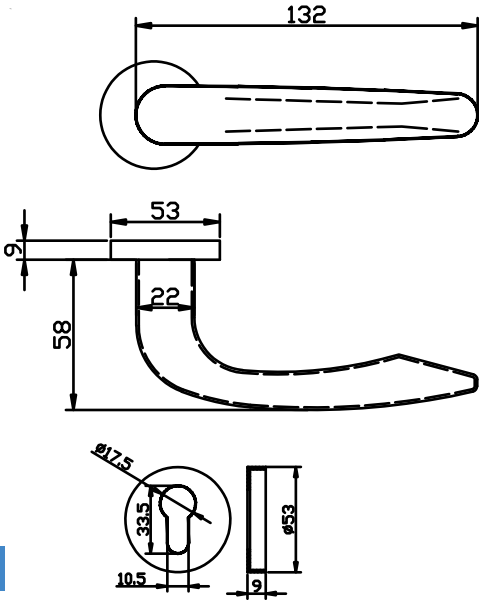
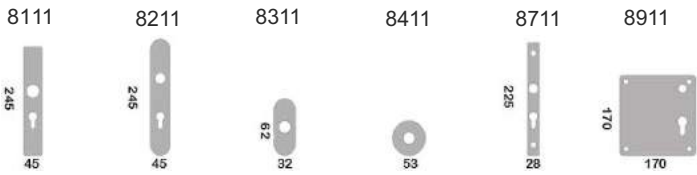

HERRAJES AUSERE - Catalog

Ausere Hardware *Spain*

Tubular lever handles
Stainless steel AISI 304 - AISI 316



Model code 8412

Tubular lever handle set with keyholes all made of stainless steel complying all to the international specifications of quality. Double plates on rosette. Interior rosette for installations on stainless steel. Exterior rosette for embellishing of stainless steel. Installation through screws of stainless steel that are included. 8 mm spindle of treated iron. Recovery of handle through treated spring of very high quality. Screws and allen key included individual packing per set. Finishes: SSS – PSS – PVD.

Manufactured according to the requirements of the standard EN 1906:2012.
Fire resistance 132 min. 200.000 cycles.

4	7	-	B	1	4	0	B
---	---	---	---	---	---	---	---

Code model for other plates

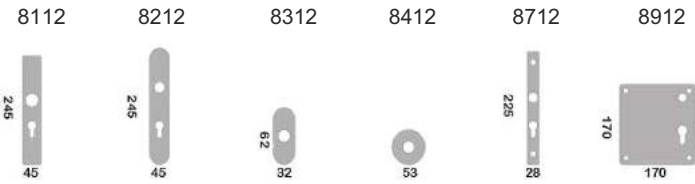

HERRAJES AUSERE - Catalog



Model code 8420

Solid lever handle set with keyholes all made of stainless steel complying all to the international specifications of quality. Double plates on rosette. Interior rosette for installations on stainless steel. Exterior rosette for embellishing of stainless steel. Installation through screws of stainless steel that are included. 8 mm spindle of treated iron. Recovery of handle through treated spring of very high quality screws and allen key included individual packing per set. Finishes SSS – PSS – PVD.

Manufactured according to the requirements of the standard EN 1906:2012.
Fire resistance 132 min. 200.000 cycles.

4	7	-	B	1	4	0	B
---	---	---	---	---	---	---	---

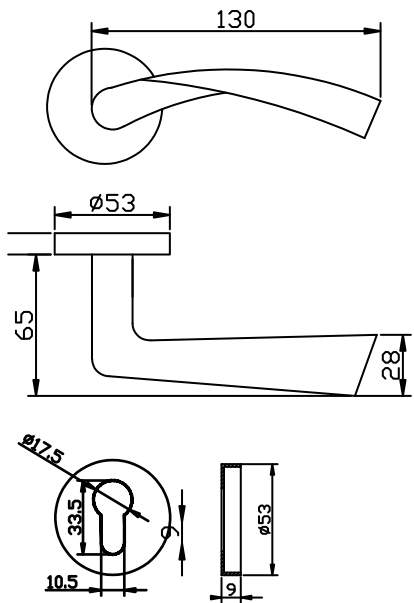

Code model for other plates

8120	8220	8320	8420	8720	8920
245	245	62	53	225	170
45	45	32		28	170



Model code 8421

Solid lever handle set with keyholes all made of stainless steel complying all to the international specifications of quality. Double plates on rosette. Interior rosette for installations on stainless steel. Exterior rosette for embellishing of stainless steel. Installation through screws of stainless steel that are included. 8 mm spindle of treated iron. Recovery of handle through treated spring of very high quality screws and allen key included individual packing per set. Finishes SSS – PSS – PVD.

Manufactured according to the requirements of the standard EN 1906:2012.
Fire resistance 132 min. 200.000 cycles.

4	7	-	B	1	4	0	B
---	---	---	---	---	---	---	---

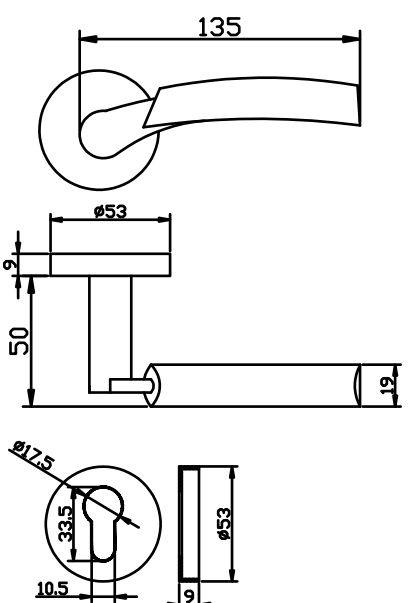

Code model for other plates

8121	8221	8321	8421	8721	8921
245	245	62	53	225	170
45	45	32		28	170

Solid lever handles
Stainless steel AISI 304 - AISI 316

Ausere Hardware *Spain*







Model code 8422

Solid lever handle set with keyholes all made of stainless steel complying all to the international specifications of quality. Double plates on rosette. Interior rosette for installations on stainless steel. Exterior rosette for embellishing of stainless steel. Installation through screws of stainless steel that are included. 8 mm spindle of treated iron. Recovery of handle through treated spring of very high quality screws and allen key included individual packing per set. Finishes SSS – PSS – PVD.

Manufactured according to the requirements of the standard EN 1906:2012.
Fire resistance 132 min. 200.000 cycles.

4	7	-	B	1	4	0	B
---	---	---	---	---	---	---	---

Code model for other plates

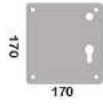
8122	8222	8322	8422	8722	8922
					
245	245	62	53	225	170
45	45	32		28	170

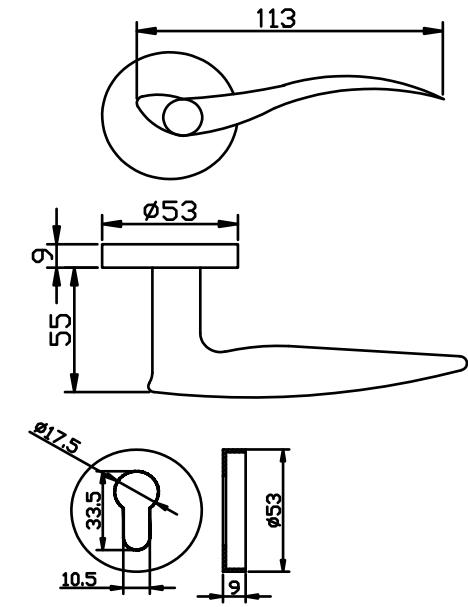

HERRAJES AUSERE - Catalog

Ausere Hardware *Spain*

Solid lever handles
Stainless steel AISI 304 - AISI 316



Model code 8423

Solid lever handle set with keyholes all made of stainless steel complying all to the international specifications of quality. Double plates on rosette. Interior rosette for installations on stainless steel. Exterior rosette for embellishing of stainless steel. Installation through screws of stainless steel that are included. 8 mm spindle of treated iron. Recovery of handle through treated spring of very high quality screws and allen key included individual packing per set. Finishes SSS – PSS – PVD.

Manufactured according to the requirements of the standard EN 1906:2012.
Fire resistance 132 min. 200.000 cycles.

4	7	-	B	1	4	0	B
---	---	---	---	---	---	---	---

Code model for other plates

8123	8223	8323	8423	8723	8923
					
245	245	62	53	225	170
45	45	32		28	170

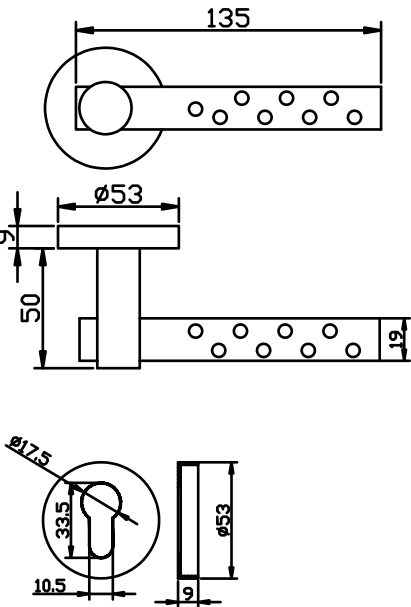

HERRAJES AUSERE - Catalog







Model code 8424

Solid lever handle set with keyholes all made of stainless steel complying all to the international specifications of quality. Double plates on rosette. Interior rosette for installations on stainless steel. Exterior rosette for embellishing of stainless steel. Installation through screws of stainless steel that are included. 8 mm spindle of treated iron. Recovery of handle through treated spring of very high quality screws and allen key included individual packing per set. Finishes SSS – PSS – PVD.

Manufactured according to the requirements of the standard EN 1906:2012.
Fire resistance 132 min. 200.000 cycles.

4	7	-	B	1	4	0	B
---	---	---	---	---	---	---	---

Code model for other plates

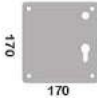
8124	8224	8324	8424	8724	8924
					
245	245	82	53	225	170
45	45	32		28	170

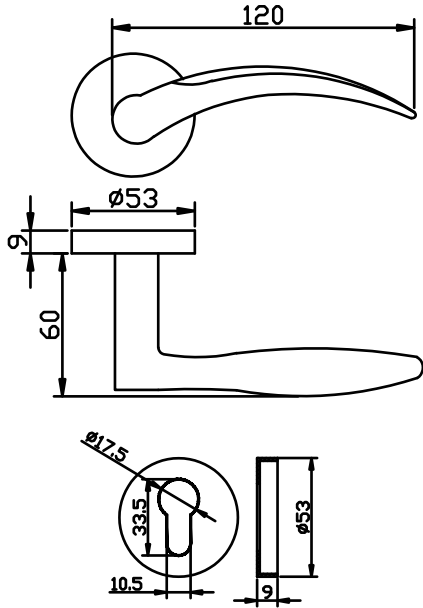





Model code 8425

Solid lever handle set with keyholes all made of stainless steel complying all to the international specifications of quality. Double plates on rosette. Interior rosette for installations on stainless steel. Exterior rosette for embellishing of stainless steel. Installation through screws of stainless steel that are included. 8 mm spindle of treated iron. Recovery of handle through treated spring of very high quality screws and allen key included individual packing per set. Finishes SSS – PSS – PVD.

Manufactured according to the requirements of the standard EN 1906:2012.
Fire resistance 132 min. 200.000 cycles.

4	7	-	B	1	4	0	B
---	---	---	---	---	---	---	---

Code model for other plates

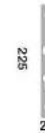
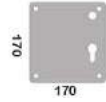
8125	8225	8325	8425	8725	8925
					
245	245	82	53	225	170
45	45	32		28	170





Model code 8426

Solid lever handle set with keyholes all made of stainless steel complying all to the international specifications of quality. Double plates on rosette. Interior rosette for installations on stainless steel. Exterior rosette for embellishing of stainless steel. Installation through screws of stainless steel that are included. 8 mm spindle of treated iron. Recovery of handle through treated spring of very high quality screws and allen key included individual packing per set. Finishes SSS – PSS – PVD.

Manufactured according to the requirements of the standard EN 1906:2012.
Fire resistance 132 min. 200.000 cycles.

4	7	-	B	1	4	0	B
---	---	---	---	---	---	---	---

Code model for other plates

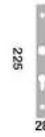
8126	8226	8326	8426	8726	8926
					
245	245	62	53	225	170
45	45	32		28	170

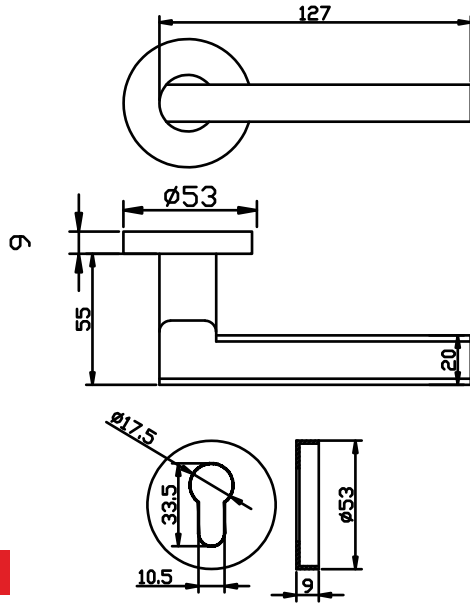





Model code 8427

Solid lever handle set with keyholes all made of stainless steel complying all to the international specifications of quality. Double plates on rosette. Interior rosette for installations on stainless steel. Exterior rosette for embellishing of stainless steel. Installation through screws of stainless steel that are included. 8 mm spindle of treated iron. Recovery of handle through treated spring of very high quality screws and allen key included individual packing per set. Finishes SSS – PSS – PVD.

Manufactured according to the requirements of the standard EN 1906:2012.
Fire resistance 132 min. 200.000 cycles.

4	7	-	B	1	4	0	B
---	---	---	---	---	---	---	---

Code model for other plates

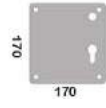
8127	8227	8327	8427	8727	8927
					
245	245	62	53	225	170
45	45	32		28	170



Model code 8428

Solid lever handle set with keyholes all made of stainless steel complying all to the international specifications of quality. Double plates on rosette. Interior rosette for installations on stainless steel. Exterior rosette for embellishing of stainless steel. Installation through screws of stainless steel that are included. 8 mm spindle of treated iron. Recovery of handle through treated spring of very high quality screws and allen key included individual packing per set. Finishes SSS – PSS – PVD.

Manufactured according to the requirements of the standard EN 1906:2012.
Fire resistance 132 min. 200.000 cycles.

4	7	-	B	1	4	0	B
---	---	---	---	---	---	---	---

Code model for other plates

8128	8228	8328	8428	8728	8928

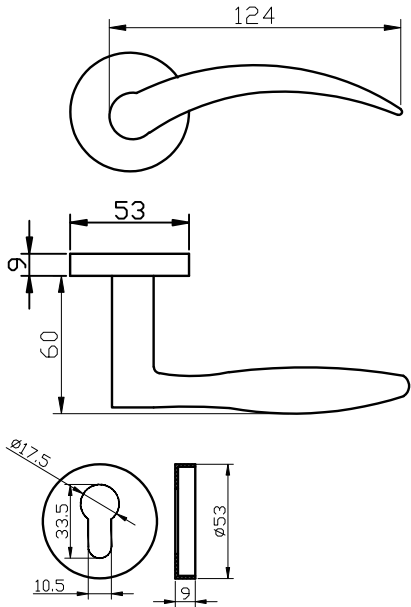

Model code 8429

Solid lever handle set with keyholes all made of stainless steel complying all to the international specifications of quality. Double plates on rosette. Interior rosette for installations on stainless steel. Exterior rosette for embellishing of stainless steel. Installation through screws of stainless steel that are included. 8 mm spindle of treated iron. Recovery of handle through treated spring of very high quality screws and allen key included individual packing per set. Finishes SSS – PSS – PVD.

Manufactured according to the requirements of the standard EN 1906:2012.
Fire resistance 132 min. 200.000 cycles.

4	7	-	B	1	4	0	B
---	---	---	---	---	---	---	---

Code model for other plates

8129	8229	8329	8429	8729	8929



Model code 8430

Solid lever handle set with keyholes all made of stainless steel complying all to the international specifications of quality. Double plates on rosette. Interior rosette for installations on stainless steel. Exterior rosette for embellishing of stainless steel. Installation through screws of stainless steel that are included. 8 mm spindle of treated iron. Recovery of handle through treated spring of very high quality screws and allen key included individual packing per set. Finishes SSS – PSS – PVD.

Manufactured according to the requirements of the standard EN 1906:2012.
Fire resistance 132 min. 200.000 cycles.

4	7	-	B	1	4	0	B
---	---	---	---	---	---	---	---

Code model for other plates

8130	8230	8330	8430	8730	8930

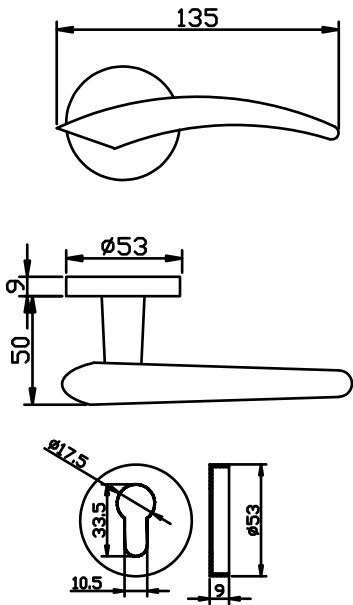

Model code 8431

Solid lever handle set with keyholes all made of stainless steel complying all to the international specifications of quality. Double plates on rosette. Interior rosette for installations on stainless steel. Exterior rosette for embellishing of stainless steel. Installation through screws of stainless steel that are included. 8 mm spindle of treated iron. Recovery of handle through treated spring of very high quality screws and allen key included individual packing per set. Finishes SSS – PSS – PVD.

Manufactured according to the requirements of the standard EN 1906:2012.
Fire resistance 132 min. 200.000 cycles.

4	7	-	B	1	4	0	B
---	---	---	---	---	---	---	---

Code model for other plates

8131	8231	8331	8431	8731	8931

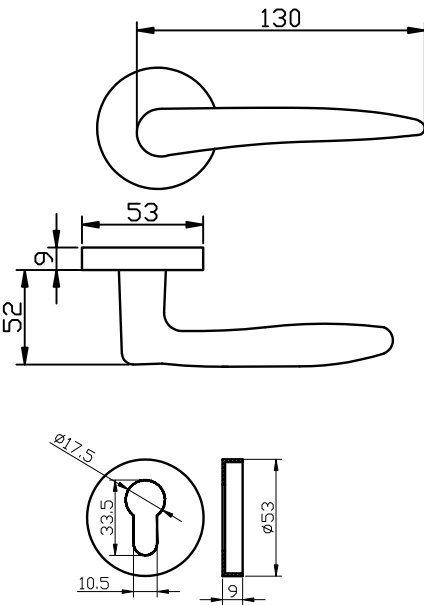

Solid lever handles
Stainless steel AISI 304 - AISI 316

Ausere Hardware *Spain*









Model code 8432

Solid lever handle set with keyholes all made of stainless steel complying all to the international specifications of quality. Double plates on rosette. Interior rosette for installations on stainless steel. Exterior rosette for embellishing of stainless steel. Installation through screws of stainless steel that are included. 8 mm spindle of treated iron. Recovery of handle through treated spring of very high quality screws and allen key included individual packing per set. Finishes SSS – PSS – PVD.

Manufactured according to the requirements of the standard EN 1906:2012.
Fire resistance 132 min. 200.000 cycles.

4	7	-	B	1	4	0	B
---	---	---	---	---	---	---	---

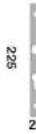
Code model for other plates

8132	8232	8332	8432	8732	8932
					
245	245	62	53	225	170
45	45	32		28	

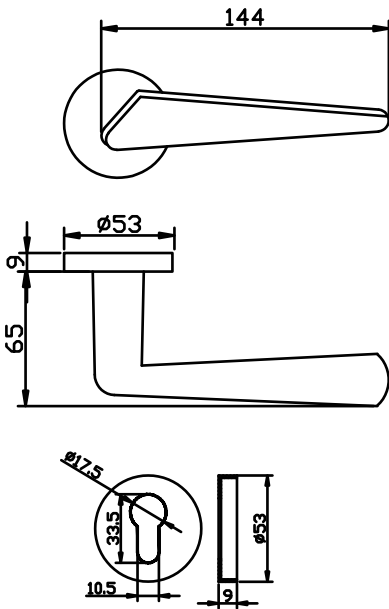

HERRAJES AUSERE - Catalog

Ausere Hardware *Spain*

Solid lever handles
Stainless steel AISI 304 - AISI 316







Model code 8433

Solid lever handle set with keyholes all made of stainless steel complying all to the international specifications of quality. Double plates on rosette. Interior rosette for installations on stainless steel. Exterior rosette for embellishing of stainless steel. Installation through screws of stainless steel that are included. 8 mm spindle of treated iron. Recovery of handle through treated spring of very high quality screws and allen key included individual packing per set. Finishes SSS – PSS – PVD.

Manufactured according to the requirements of the standard EN 1906:2012.
Fire resistance 132 min. 200.000 cycles.

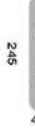
4	7	-	B	1	4	0	B
---	---	---	---	---	---	---	---

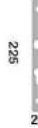
Code model for other plates

8133	8233	8333	8433	8733	8933
					
245	245	62	53	225	170
45	45	32		28	

HERRAJES AUSERE - Catalog

Solid lever handles
Stainless steel AISI 304 - AISI 316

Ausere Hardware *Spain*





Model code 8434

Solid lever handle set with keyholes all made of stainless steel complying all to the international specifications of quality. Double plates on rosette. Interior rosette for installations on stainless steel. Exterior rosette for embellishing of stainless steel. Installation through screws of stainless steel that are included. 8 mm spindle of treated iron. Recovery of handle through treated spring of very high quality screws and allen key included individual packing per set. Finishes SSS – PSS – PVD.

Manufactured according to the requirements of the standard EN 1906:2012.
Fire resistance 132 min. 200.000 cycles.

4	7	-	B	1	4	0	B
---	---	---	---	---	---	---	---

Code model for other plates

8134	8234	8334	8434	8734	8934
					

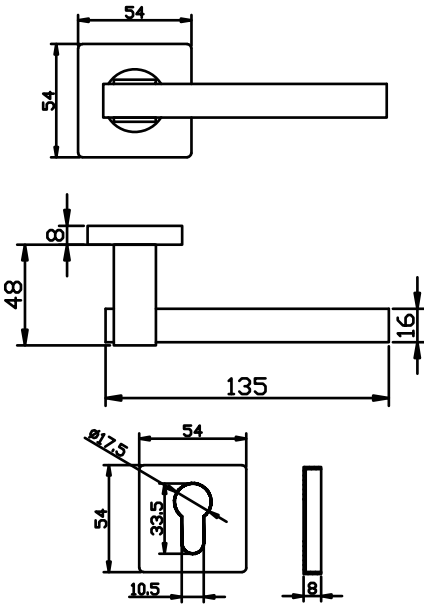

HERRAJES AUSERE - Catalog

Ausere Hardware *Spain*

Solid lever handles
Stainless steel AISI 304 - AISI 316







Model code 8435

Solid lever handle set with keyholes all made of stainless steel complying all to the international specifications of quality. Double plates on rosette. Interior rosette for installations on stainless steel. Exterior rosette for embellishing of stainless steel. Installation through screws of stainless steel that are included. 8 mm spindle of treated iron. Recovery of handle through treated spring of very high quality screws and allen key included individual packing per set. Finishes SSS – PSS – PVD.

Manufactured according to the requirements of the standard EN 1906:2012.
Fire resistance 132 min. 200.000 cycles.

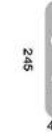
4	7	-	B	1	4	0	B
---	---	---	---	---	---	---	---

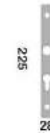
Code model for other plates

8135	8235	8335	8435	8735	8935
					

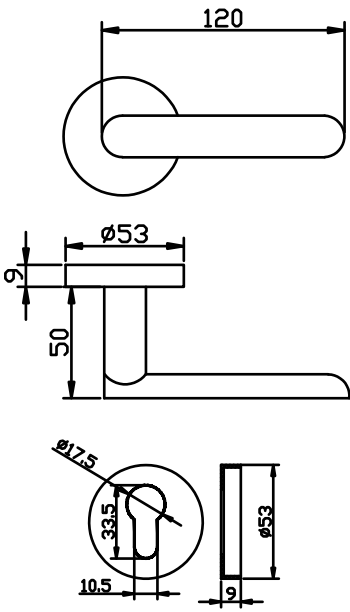

HERRAJES AUSERE - Catalog

Solid lever handles
Stainless steel AISI 304 - AISI 316

Ausere Hardware *Spain*





Model code 8436

Solid lever handle set with keyholes all made of stainless steel complying all to the international specifications of quality. Double plates on rosette. Interior rosette for installations on stainless steel. Exterior rosette for embellishing of stainless steel. Installation through screws of stainless steel that are included. 8 mm spindle of treated iron. Recovery of handle through treated spring of very high quality screws and allen key included individual packing per set. Finishes SSS – PSS – PVD.

Manufactured according to the requirements of the standard EN 1906:2012.
Fire resistance 132 min. 200.000 cycles.

4	7	-	B	1	4	0	B
---	---	---	---	---	---	---	---

Code model for other plates

8136	8236	8336	8436	8736	8936
					
245	245	62	53	226	170

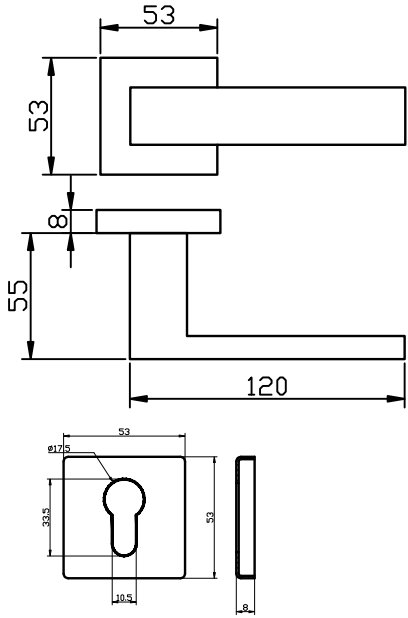

HERRAJES AUSERE - Catalog

Ausere Hardware *Spain*

Solid lever handles
Stainless steel AISI 304 - AISI 316



Model code 8437

Solid lever handle set with keyholes all made of stainless steel complying all to the international specifications of quality. Double plates on rosette. Interior rosette for installations on stainless steel. Exterior rosette for embellishing of stainless steel. Installation through screws of stainless steel that are included. 8 mm spindle of treated iron. Recovery of handle through treated spring of very high quality screws and allen key included individual packing per set. Finishes SSS – PSS – PVD.

Manufactured according to the requirements of the standard EN 1906:2012.
Fire resistance 132 min. 200.000 cycles.

4	7	-	B	1	4	0	B
---	---	---	---	---	---	---	---

Code model for other plates

8137	8237	8337	8437	8737	8937
					
245	245	62	53	226	170

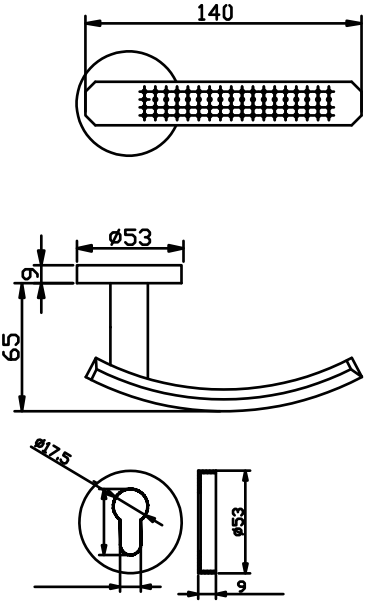

HERRAJES AUSERE - Catalog

Solid lever handles
Stainless steel AISI 304 - AISI 316

Ausere Hardware *Spain*



Model code 8438

Solid lever handle set with keyholes all made of stainless steel complying all to the international specifications of quality. Double plates on rosette. Interior rosette for installations on stainless steel. Exterior rosette for embellishing of stainless steel. Installation through screws of stainless steel that are included. 8 mm spindle of treated iron. Recovery of handle through treated spring of very high quality screws and allen key included individual packing per set. Finishes SSS – PSS – PVD.

Manufactured according to the requirements of the standard EN 1906:2012.
Fire resistance 132 min. 200.000 cycles.

4	7	-	B	1	4	0	B
---	---	---	---	---	---	---	---

Code model for other plates

8138	8238	8338	8438	8738	8938

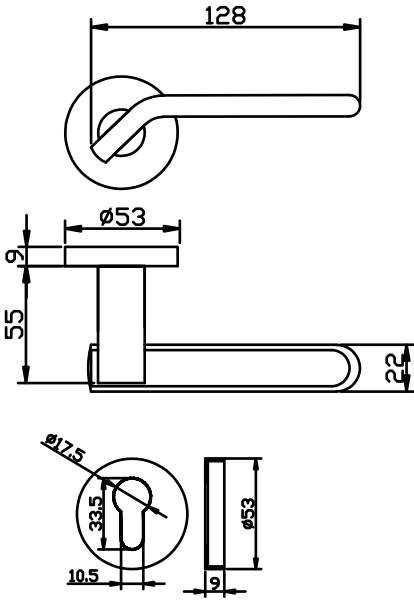

HERRAJES AUSERE - Catalog

Ausere Hardware *Spain*

Solid lever handles
Stainless steel AISI 304 - AISI 316



Model code 8439

Solid lever handle set with keyholes all made of stainless steel complying all to the international specifications of quality. Double plates on rosette. Interior rosette for installations on stainless steel. Exterior rosette for embellishing of stainless steel. Installation through screws of stainless steel that are included. 8 mm spindle of treated iron. Recovery of handle through treated spring of very high quality screws and allen key included individual packing per set. Finishes SSS – PSS – PVD.

Manufactured according to the requirements of the standard EN 1906:2012.
Fire resistance 132 min. 200.000 cycles.

4	7	-	B	1	4	0	B
---	---	---	---	---	---	---	---

Code model for other plates

8139	8239	8339	8439	8739	8939

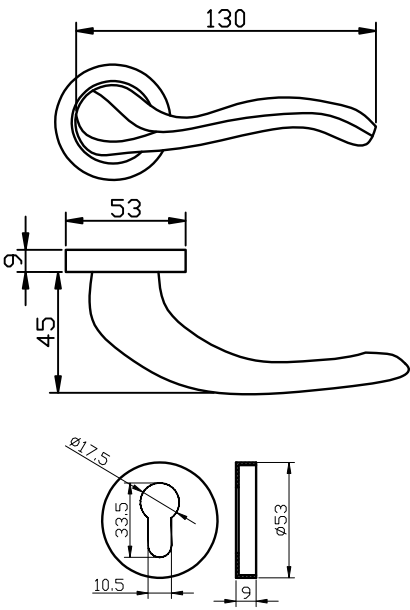

HERRAJES AUSERE - Catalog

Plates

Stainless steel AISI 304 - AISI 316

Ausere Hardware *Spain*



Model code 8201

Tubular lever handle set all made of stainless steel complying all to the international specifications of quality. Double plates. Interior plate for installations on stainless steel. Exterior oval plate for embellishing of stainless steel. Installation through screws of stainless steel that are included. 8 mm spindle of treated iron. Recovery of handle through treated spring of very high quality. Screws and allen key included. Individual packing per set. Finishes SSS – PSS – PVD.

Manufactured according to standard EN 1906:2012.
Cheked in external European laboratory with code

3	7	-	1	1	4	3	B
---	---	---	---	---	---	---	---

Code model for other plates

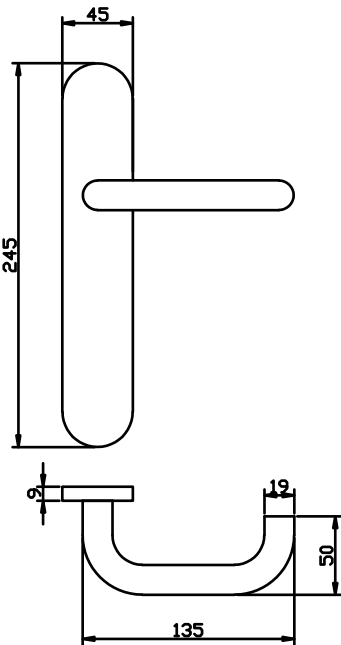
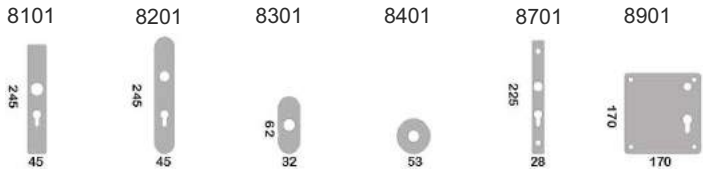

HERRAJES AUSERE - Catalog

Ausere Hardware *Spain*

Plates

Stainless steel AISI 304 - AISI 316



Model code 8202

Tubular lever handle set all made of stainless steel complying all to the international specifications of quality. Double plates. Interior plate for installations on stainless steel. Exterior oval plate for embellishing of stainless steel. Installation through screws of stainless steel that are included. 8 mm spindle of treated iron. Recovery of handle through treated spring of very high quality. Screws and allen key included. Individual packing per set. Finishes SSS – PSS – PVD.

Manufactured according to standard EN 1906:2012.
Cheked in external European laboratory with code

3	7	-	1	1	4	3	B
---	---	---	---	---	---	---	---

Code model for other plates

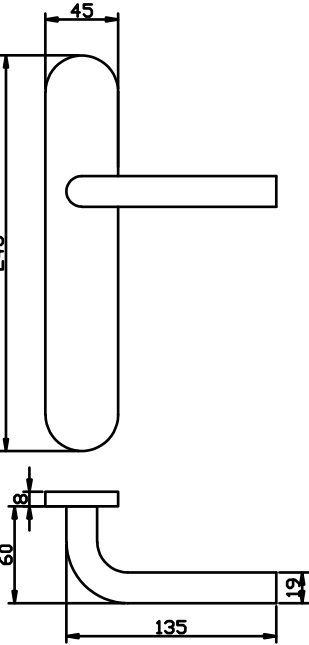
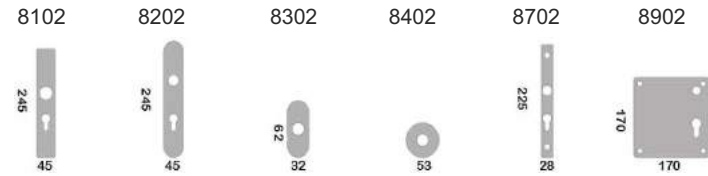

HERRAJES AUSERE - Catalog



Model code 8203

Tubular lever handle set all made of stainless steel complying all to the international specifications of quality. Double plates. Interior plate for installations on stainless steel. Exterior oval plate for embellishing of stainless steel. Installation through screws of stainless steel that are included. 8 mm spindle of treated iron. Recovery of handle through treated spring of very high quality. Screws and allen key included. Individual packing per set. Finishes SSS – PSS – PVD.

Manufactured according to standard EN 1906:2012.
Cheked in external European laboratory with code

3	7	-	1	1	4	3	B
---	---	---	---	---	---	---	---

Code model for other plates

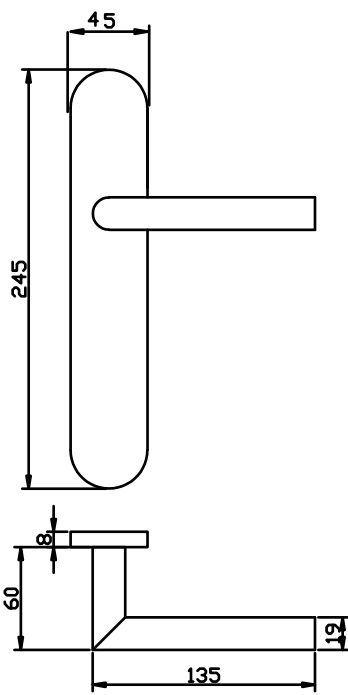
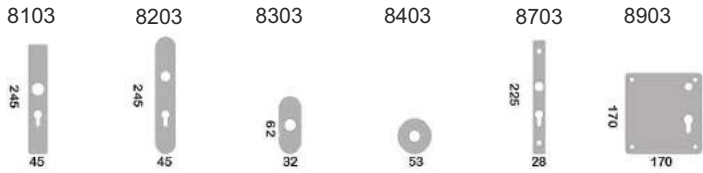

HERRAJES AUSERE - Catalog



Model code 8134

Solid lever handle set all made of stainless steel complying all to the international specifications of quality. Double plates. Interior plate for installations on stainless steel. Exterior rectangular plate for embellishing of stainless steel. Installation through screws of stainless steel that are included. 8 mm spindle of treated iron. Recovery of handle through treated spring of very high quality. Screws and allen key included. Individual packing per set.

Manufactured according to standard EN 1906:2012
Checked in external Laboratory with code

3	7	-	1	1	4	3	B
---	---	---	---	---	---	---	---

Code model for other plates

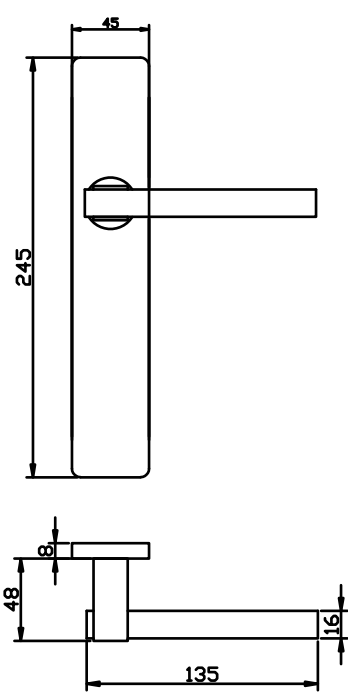
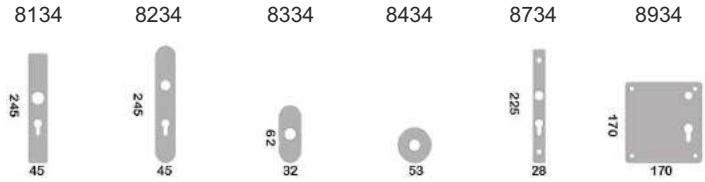

HERRAJES AUSERE - Catalog







Model code 8220

Solid lever handle set all made of stainless steel complying all to the international specifications of quality. Double plates. Interior plate for installations on stainless steel. Exterior rectangular plate for embellishing of stainless steel. Installation through screws of stainless steel that are included. 8 mm spindle of treated iron. Recovery of handle through treated spring of very high quality. Screws and allen key included. Individual packing per set.

Manufactured according to standard EN 1906:2012
Checked in external Laboratory with code

3	7	-	1	1	4	3	B
---	---	---	---	---	---	---	---

Code model for other plates

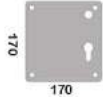
8120	8220	8320	8420	8720	8920
					
245	245	62	53	225	170
45	45	32		28	170

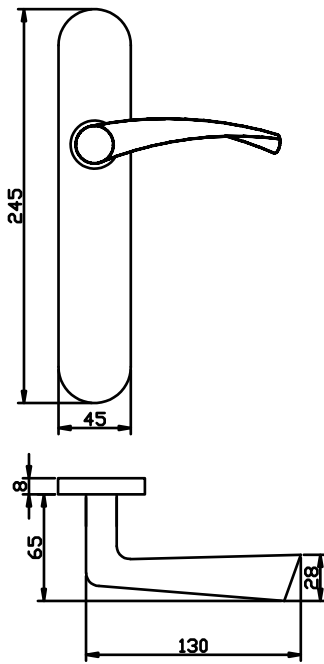

HERRAJES AUSERE - Catalog





Model code 8221

Solid lever handle set all made of stainless steel complying all to the international specifications of quality. Double plates. Interior plate for installations on stainless steel. Exterior rectangular plate for embellishing of stainless steel. Installation through screws of stainless steel that are included. 8 mm spindle of treated iron. Recovery of handle through treated spring of very high quality. Screws and allen key included. Individual packing per set.

Manufactured according to standard EN 1906:2012
Checked in external Laboratory with code

3	7	-	1	1	4	3	B
---	---	---	---	---	---	---	---

Code model for other plates

8121	8221	8321	8421	8721	8921
					
245	245	62	53	225	170
45	45	32		28	170

HERRAJES AUSERE - Catalog







Model code 8301

Tubular lever handle set all made of stainless steel complying all to the international specifications of quality. Double plates on oval rosette. Interior oval rosette for installations on stainless steel. Exterior oval rosette for embellishing of stainless steel. Installation through screws of stainless steel that are included. 8 mm spindle of treated iron. Recovery of handle through treated spring of very high quality. Screws and allen key included. Individual packing per set. Finishes SSS – PSS – PVD.

Manufactured according to standard EN 1906:2012.
Cheked in external European laboratory with code

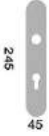
3	7	-	1	1	4	3	B
---	---	---	---	---	---	---	---

Code model for other plates

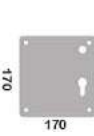
8101	8201	8301	8401	8701	8901
					

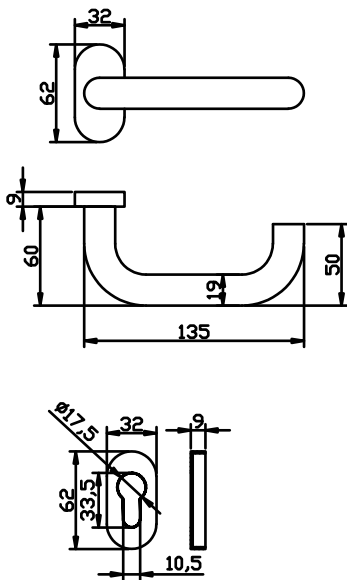







Model code 8302

Tubular lever handle set all made of stainless steel complying all to the international specifications of quality. Double plates on oval rosette. Interior oval rosette for installations on stainless steel. Exterior oval rosette for embellishing of stainless steel. Installation through screws of stainless steel that are included. 8 mm spindle of treated iron. Recovery of handle through treated spring of very high quality. Screws and allen key included. Individual packing per set. Finishes SSS – PSS – PVD.

Manufactured according to standard EN 1906:2012.
Cheked in external European laboratory with code

3	7	-	1	1	4	3	B
---	---	---	---	---	---	---	---

Code model for other plates

8102	8202	8302	8402	8702	8902
					









Model code 8320

Solid lever handle set all made of stainless steel AISI 304, AISI 316 complying all to the international specifications of quality. Double plates on oval rosette. Interior oval rosette for installations on stainless steel. Exterior oval rosette for embellishing of stainless steel AISI 304. Installation through screws of stainless steel that are included. 8 mm spindle of treated iron. Recovery of handle through treated spring of very high quality. Screws and Ilen key included. Individual packing per set. Finishes SS – PSS – PVD.

Manufactured according to standard EN 1906:2012.
Cheked in external European laboratory with code

3	7	-	1	1	4	3	B
---	---	---	---	---	---	---	---

Code model for other plates

8120	8220	8320	8420	8720	8920
					
245	245	62	53	225	170
45	45	32		28	170

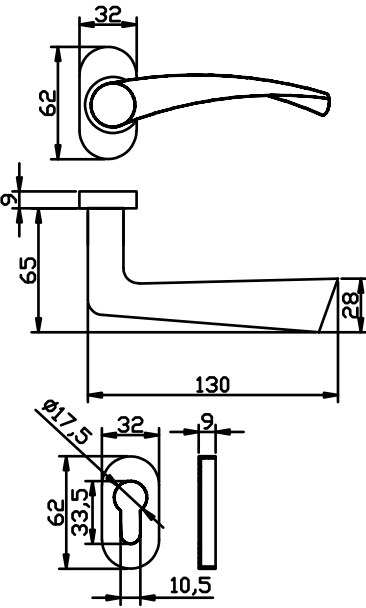

HERRAJES AUSERE - Catalog









Model code 8901

Tubular lever handle set all made of stainless steel complying all to the international specifications of quality. Exterior square plate for embellishing of stainless steel. Installation through crews of stainless steel that are included. 8 mm spindle of treated iron. Recovery of handle through treated spring of very high quality. Screws and allen key included. Individual packing per set. Finishes SSS – PSS – PVD.

Manufactured according to standard EN 1906:2012.
Cheked in external European laboratory with code

3	7	-	1	1	4	3	B
---	---	---	---	---	---	---	---

Code model for other plates

8101	8201	8301	8401	8701	8901
					
245	245	62	53	225	170
45	45	28		28	170

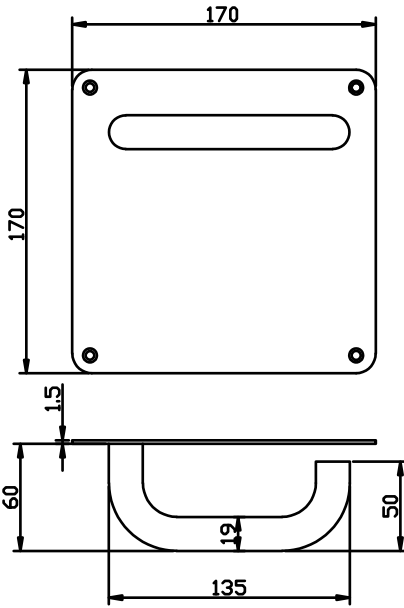

HERRAJES AUSERE - Catalog



Model code 8902

Tubular lever handle set all made of stainless steel complying all to the international specifications of quality. Exterior square plate for embellishing of stainless steel. Installation through crews of stainless steel that are included. 8 mm spindle of treated iron. Recovery of handle through treated spring of very high quality. Screws and allen key included. Individual packing per set. Finishes SSS – PSS – PVD.

Manufactured according to standard EN 1906:2012.
Cheked in external European laboratory with code

3	7	-	1	1	4	3	B
---	---	---	---	---	---	---	---

Code model for other plates

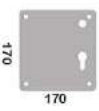
8102	8202	8302	8402	8702	8902
					
245	245	62	53	225	170
45	45	32		28	170

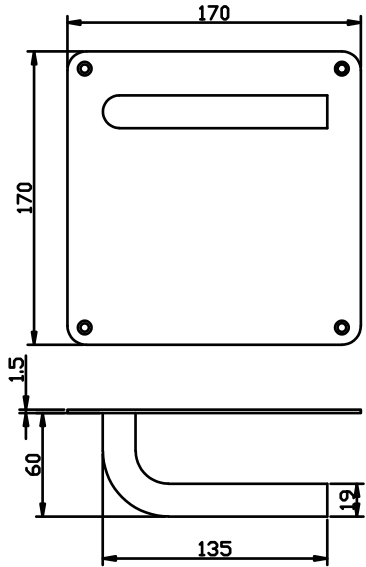

Pull handles



Pull handles

Stainless steel AISI 304 - AISI 316

Ausere Hardware *Spain*



Model code 8610

Finishes: SSS - PSS - PVD

A	B	Item no.
19	225	8610-1
19	300	8610-2
19	400	8610-3
22	225	8610-4
22	300	8610-5
22	400	8610-6
25	200	8610-7
25	300	8610-8
25	400	8610-9
25	600	8610-10
32	200	8610-11
32	300	8610-12
32	400	8610-13
32	600	8610-14
32	900	8610-15

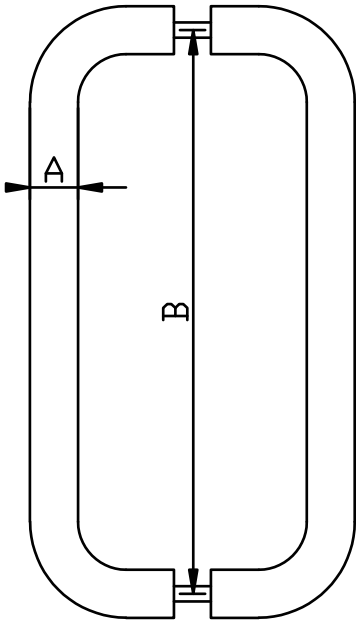

For any other size please consult

Ausere Hardware *Spain*

Pull handles

Stainless steel AISI 304 - AISI 316



Model code 8620

Finishes: SSS - PSS - PVD

A	B	C	Item no.
25	200	300	8620-1
25	300	400	8620-2
25	400	500	8620-3
25	600	700	8620-4
25	800	1000	8620-5
32	200	300	8620-6
32	300	400	8620-7
32	400	500	8620-8
32	600	700	8620-9
32	800	1000	8620-10
32	1000	1200	8620-11
32	1400	1600	8620-12

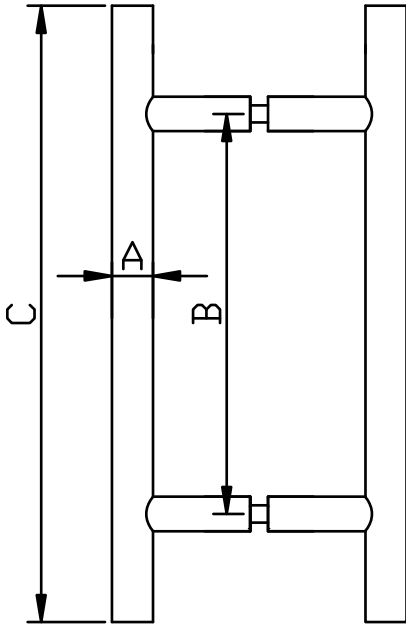

For any other size please consult

Pull handles
Stainless steel AISI 304 - AISI 316

Ausere Hardware *Spain*



Model code 8630

Finishes: SSS - PSS - PVD

A	B	Item no.
25	200	8630-1
25	300	8630-2
32	300	8630-3
32	400	8630-4

For any other size please consult

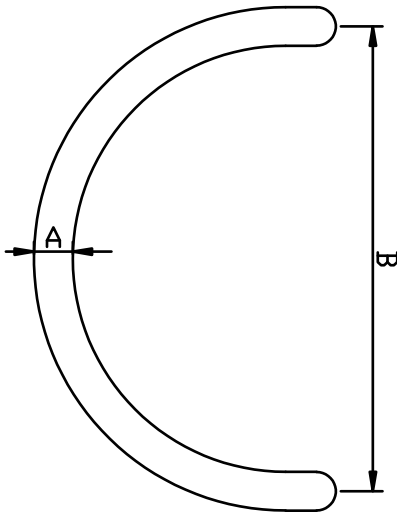

Ausere Hardware *Spain*

Pull handles
Stainless steel AISI 304 - AISI 316



Model code 8650

Finishes: SSS - PSS - PVD

A	B	Item no.
25	300	8650-1
25	400	8650-2
32	400	8650-3
32	600	8650-4

For any other size please consult

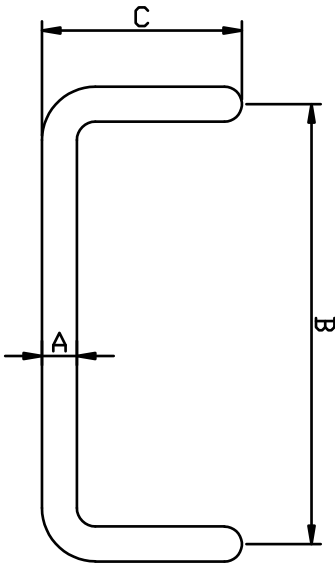

Pull handles
Stainless steel AISI 304 - AISI 316

Ausere Hardware *Spain*

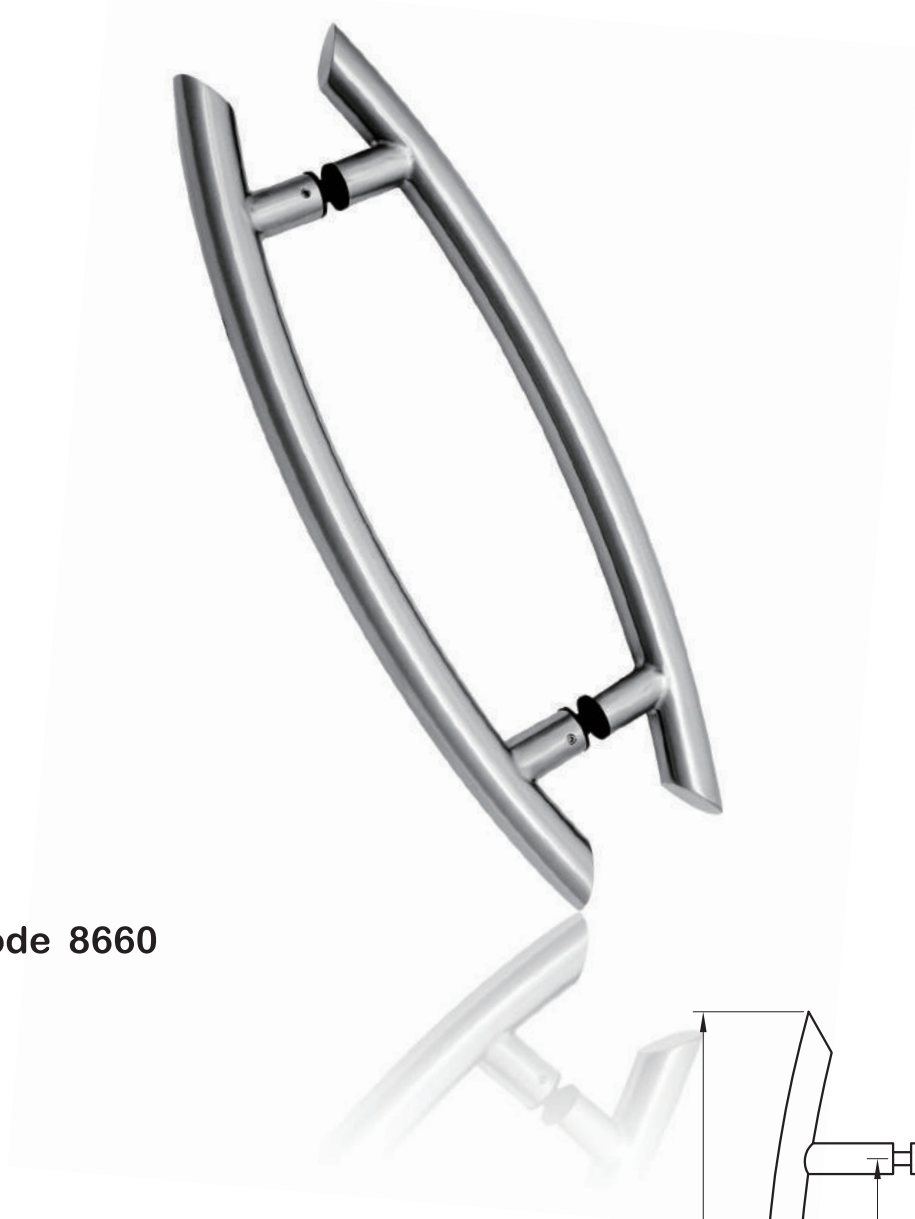

Model code 8660

Finishes: SSS - PSS - PVD

A	B	C	Item no.
25	300	400	8660-1
25	400	500	8660-2
25	500	600	8660-3

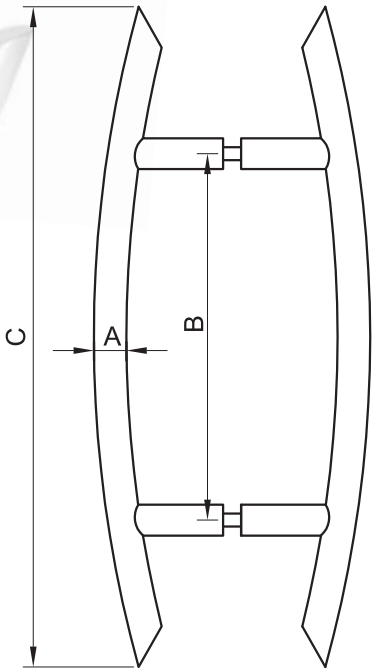

For any other size please consult

Ausere Hardware *Spain*

Pull handles
Stainless steel AISI 304 - AISI 316
Finishes: SSS - PSS - PVD



8670

A	B	Item no.
19	150	8670-1
19	200	8670-2
19	250	8670-3
19	300	8670-4

For any other size please consult

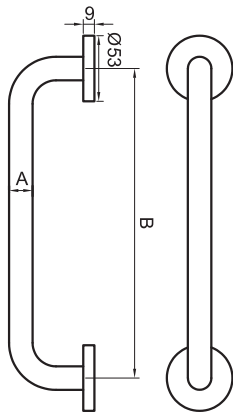

8680

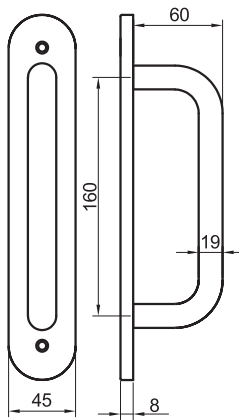

8685

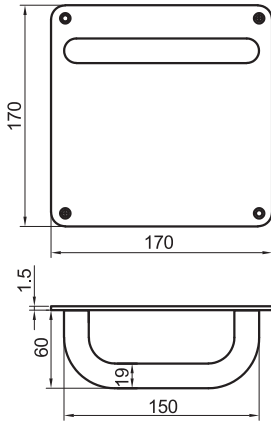

Sanitary booth hardware



Push plate

A	B	Item no.
300	75	10620
400	100	10621

For any other size please consult

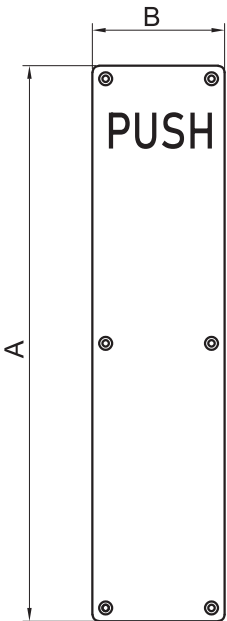

Pull plate

PLATE		PULL		Item no.
A	B	Ø	C	
300	75	22	300	10625
400	100	22	225	10626

For any other size please consult

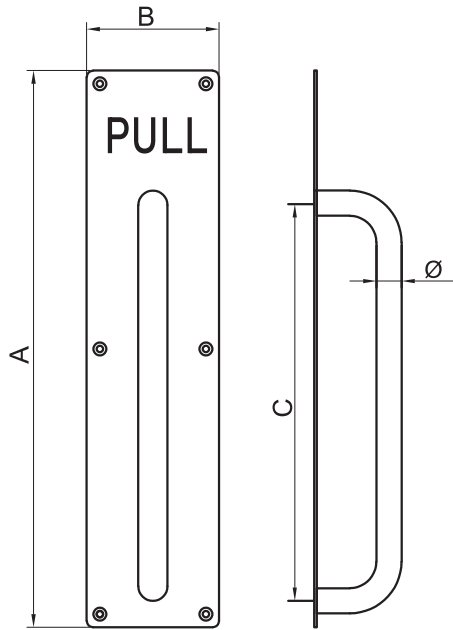

Sanytary booth hardware
Stainless steel AISI 304 - AISI 316
Finishes: SSS - PSS - PVD

Ausere Hardware *Spain*

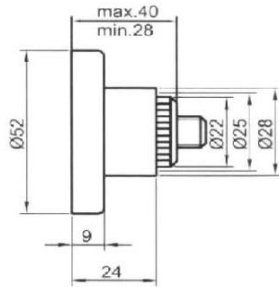

3001
Tube support for wall.
Stainless steel in AISI 304.
Screws included.

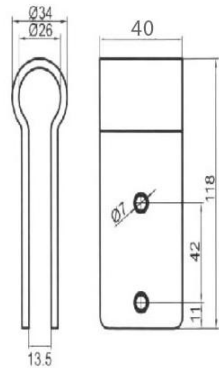

3002
Panel holder.
Stainless steel in AISI 304.
Screws included.

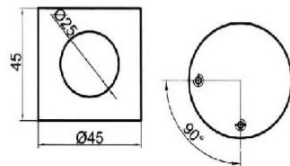

3003
"L" Shape tube connector.
Stainless steel in AISI 304.
Screws included.

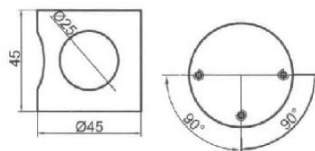

3004
"T" Shape tube connector.
Stainless steel in AISI 304.
Screws included.

Ausere Hardware *Spain*

Sanytary booth hardware
Stainless steel AISI 304 - AISI 316
Finishes: SSS - PSS - PVD

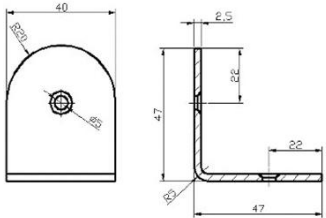

3005 R
Round angle panel support.
Stainless steel in AISI 304.
Screws included.

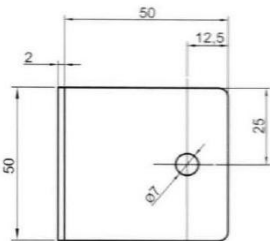

3005
Angle panel support.
Stainless steel in AISI 304.
Screws included.

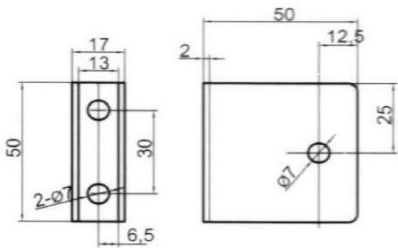

3006
"U" Shape panel support.
Stainless steel in AISI 304.
Screws included.

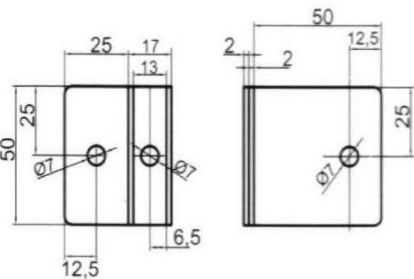

3007
"L" Shape panel support.
Stainless steel in AISI 304.
Screws included.

Sanitary booth hardware
Stainless steel AISI 304 - AISI 316
Finishes: SSS - PSS - PVD

Ausere Hardware *Spain*

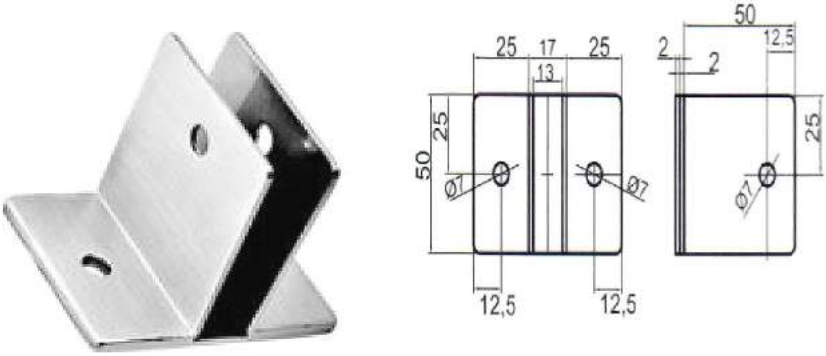

3008
"T" Shape panel support.
Stainless steel in AISI 304.
Screws included.



3009 R / 3009 L
Right hand side flat hinge.
Left hand side flat hinge.
Stainless steel in AISI 304.
Screws included.

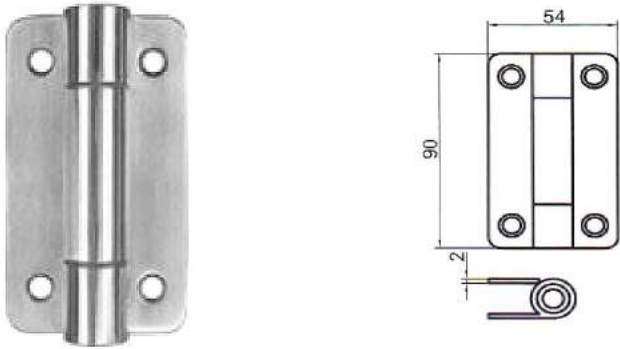

3010
Fixed hinge.
Stainless steel in AISI 304.
Screws included.

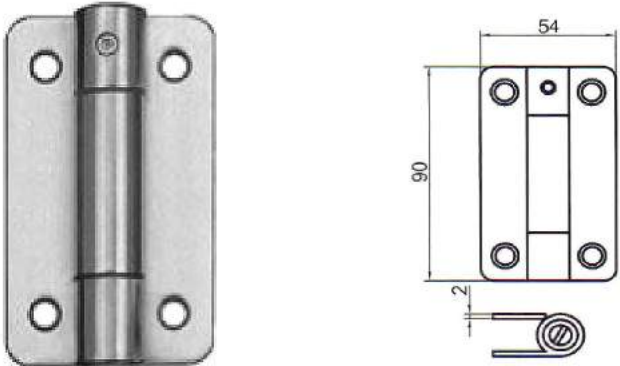

3011
Hinge with spring.
Stainless steel in AISI 304.
Screws included.

Ausere Hardware *Spain*

Sanitary booth hardware
Stainless steel AISI 304 - AISI 316
Finishes: SSS - PSS - PVD

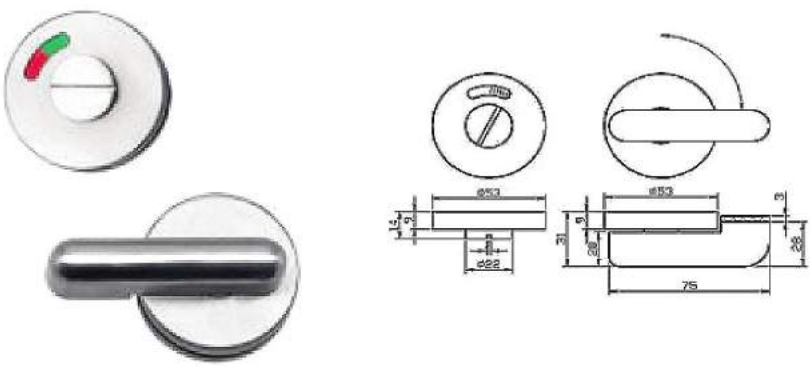

3012
Bathroom latch with indicator.
Stainless steel in AISI 304.
Screws included.

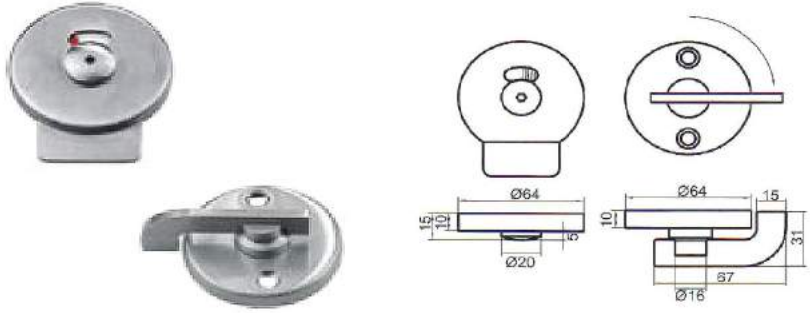

3013
Bathroom latch with indicator.
Stainless steel in AISI 304.
Screws included.

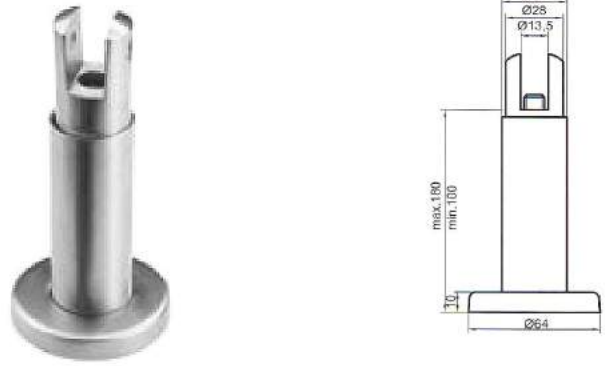

3014
Leg support adjustable in height.
Stainless steel in AISI 304.
Screws included.

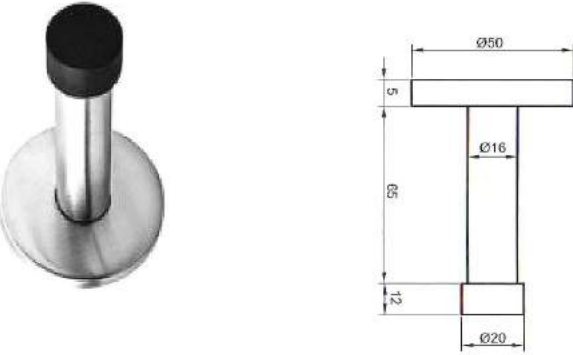

3015
Doorstop/hanger.
Stainless steel AISI 304.
Screws included.

Sanitary booth hardware
Stainless steel AISI 304 - AISI 316
 Finishes: SSS - PSS - PVD

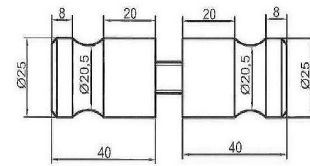

3016

Fixed knob sold by sets.
Stainless steel in AISI 304.
Screws included.

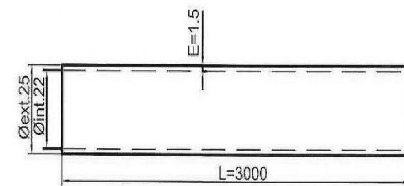
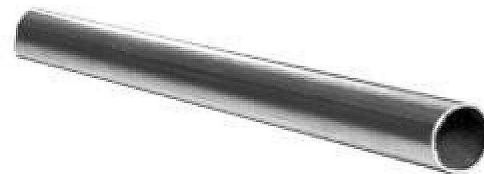

3017

Tube 25 x 3000 mm.
Stainless steel in AISI 304.

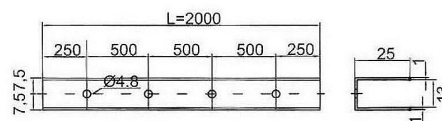
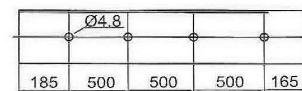
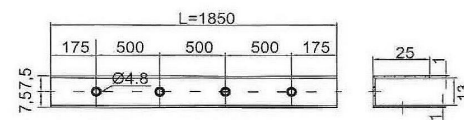
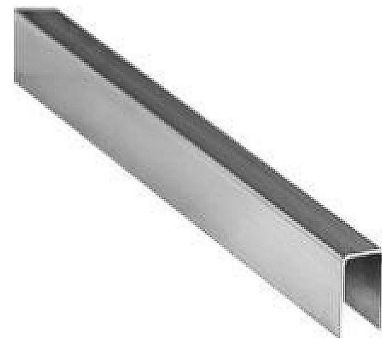

3018

"U" Shape side panel profile,
1850 mm.
Stainless steel in AISI 304.

3019

"U" Shape top/side panel profile,
2000 mm.
Stainless steel in AISI 304.

Ausere Hardware *Spain*

Sanitary booth hardware
Stainless steel AISI 304 - AISI 316
 Finishes: SSS - PSS - PVD

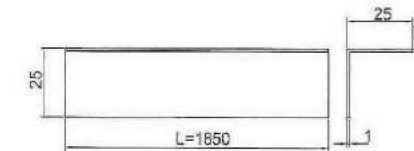
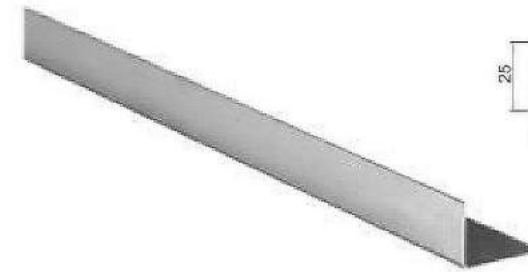

3020

"L" shape side panel profile
1850 mm.
Stainless steel in AISI 304.

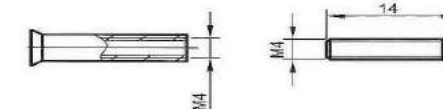

3021

Through bolt 4 x 14 mm.
Stainless steel AISI 304.

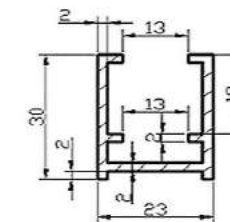

3022

"U" Shape top/side panel profile,
3700 mm.
in aluminum with inox color.

Sanitary booth hardware
Stainless steel AISI 304 - AISI 316
Finishes: SSS - PSS - PVD

Ausere Hardware *Spain*

3024

Ajustable leg.
Adapted for any panel thickness.
Stainless steel AISI 304.
Screws included.

3025

Casting wc turn and release
with indicator.
Stainless steel AISI 304
Screws included

Ausere Hardware *Spain*

Sanitary booth hardware
Stainless steel AISI 304 - AISI 316
Finishes: SSS - PSS - PVD

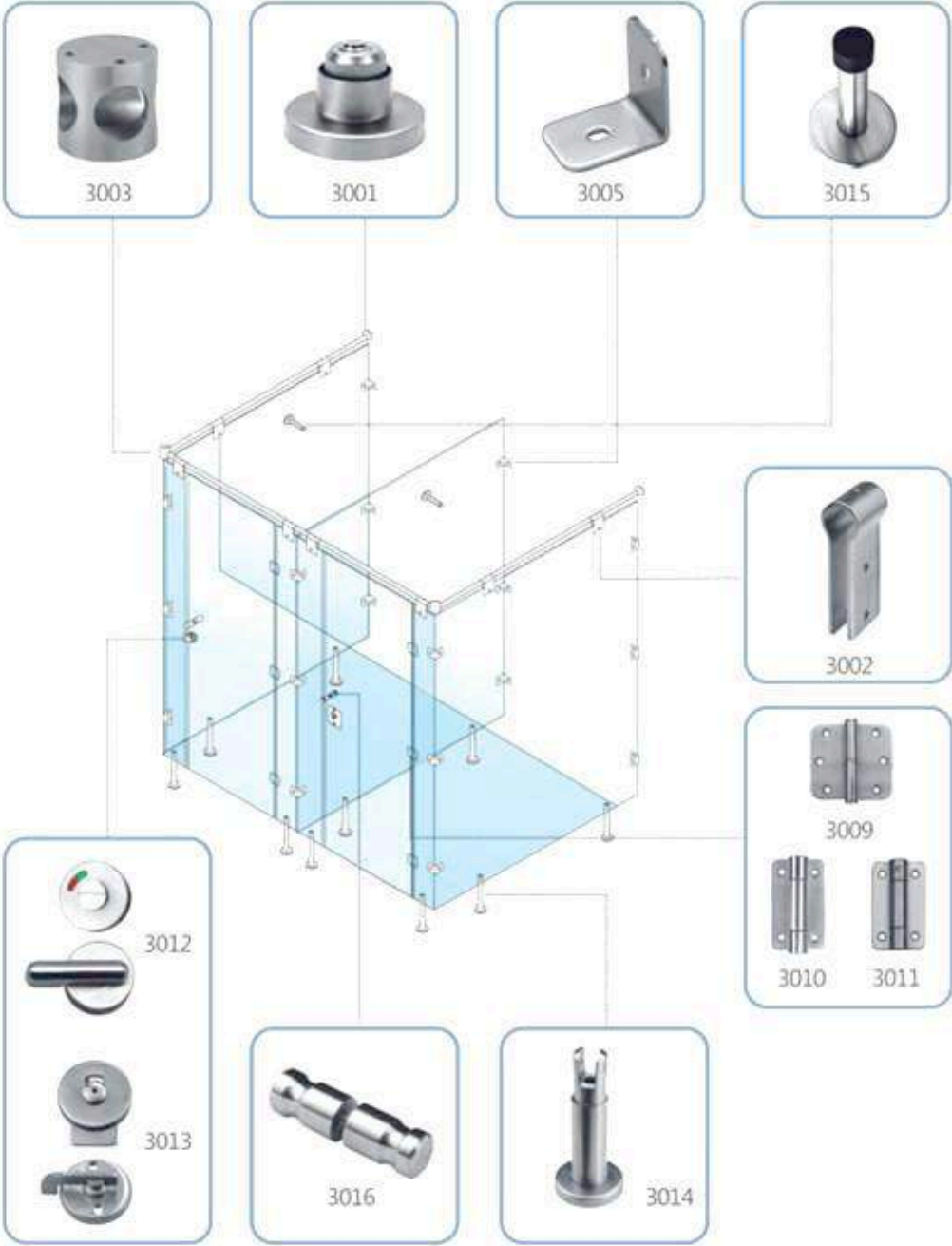

Safety bars

Stainless steel AISI 304 - AISI 316

Finishes: SSS - PSS - PVD

Ausere Hardware *Spain*

3101

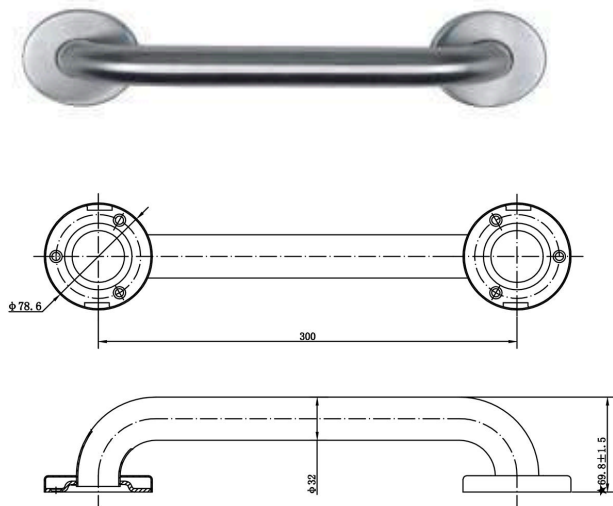

3102

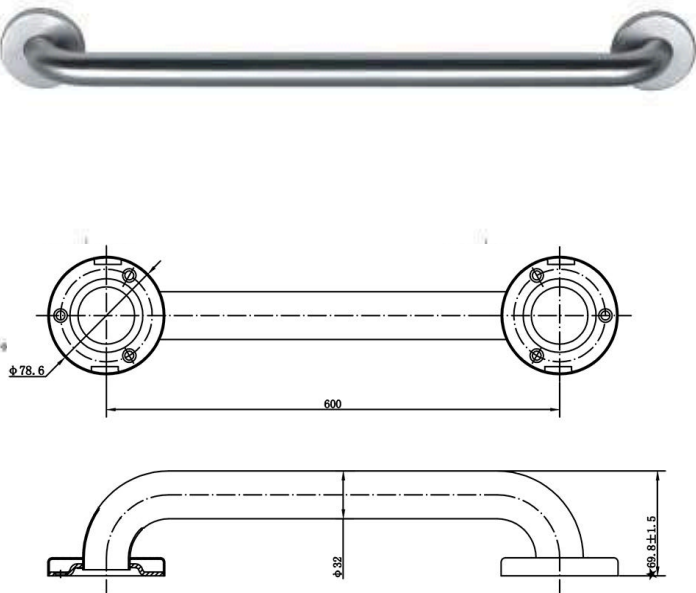

Ausere Hardware *Spain*

Safety bars

Stainless steel AISI 304 - AISI 316

Finishes: SSS - PSS - PVD

3103

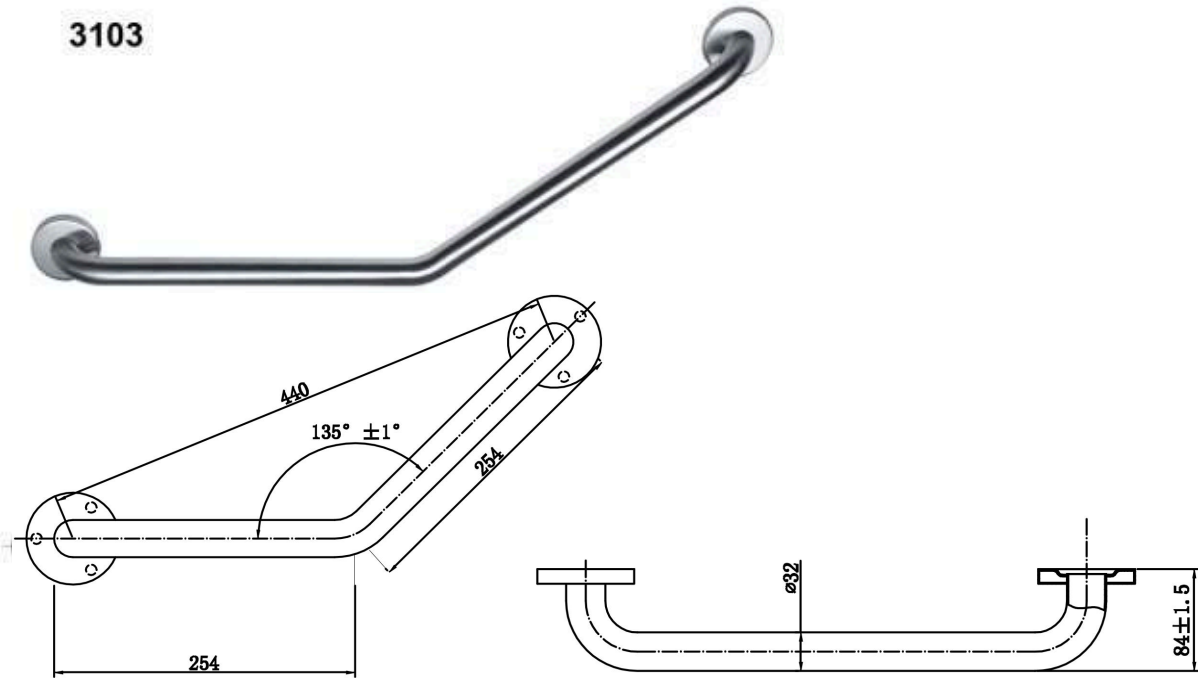

3104

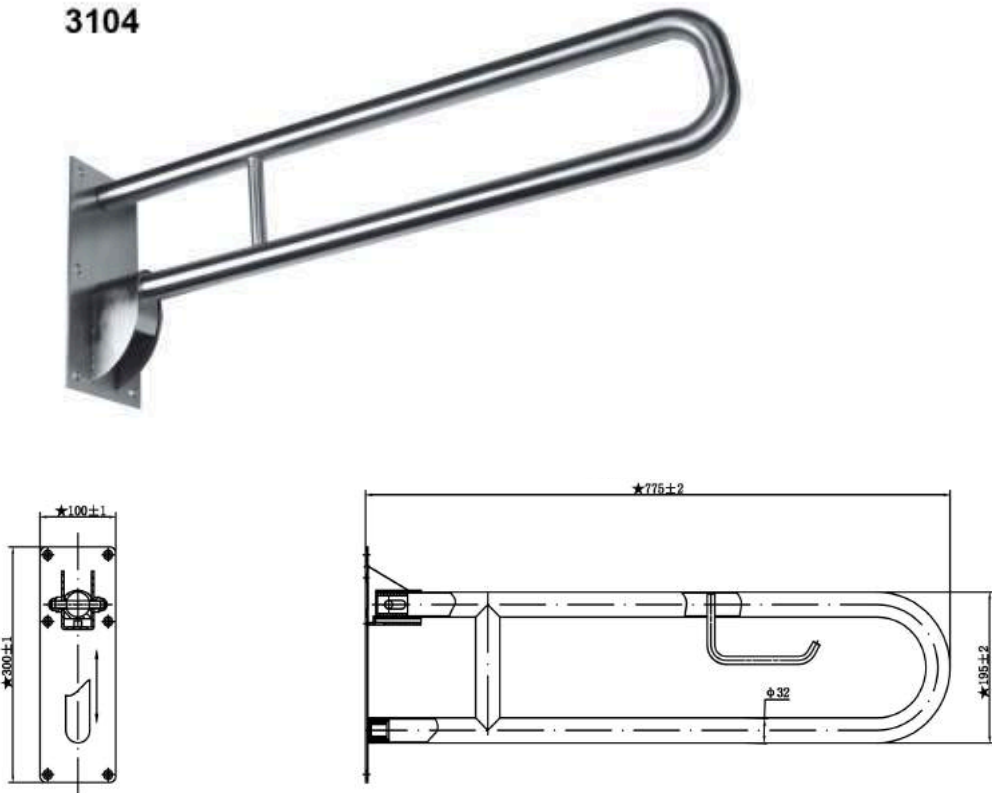

REPORT NUMBER:160913003SHF-BP-2
ORIGINAL ISSUE DATE: August 11, 2017

EVALUATION CENTER

Intertek Testing Services Ltd., Shanghai
Plant 7, No. 6958 Daye Road, Fengxian District, Shanghai, China

RENDERED TO

HERRAJES AUSERE SL
Malpica Alfinden Industrial Estate
P Street, industrial unit 5
50171 La Puebla de Alfinden (Zaragoza – Spain)

PRODUCT EVALUATED

Mortise lock
Model: 10800

EVALUATION PROPERTY

Fire Resistance

Report of Testing Mortise lock – Model of 10800 in Single Leaf Single Action Steel Fire Door for compliance with the applicable requirements of the following criteria: EN 1634-1:2014, Fire resistance and smoke control tests for door and shutter assemblies, openable windows and elements of building hardware – Part 1: Fire resistance test for door and shutter assemblies and openable windows.

"This report is for the exclusive use of Intertek's Client and is provided pursuant to the agreement between Intertek and its Client. Intertek's responsibility and liability are limited to the terms and conditions of the agreement. Intertek assumes no liability to any party, other than to the Client in accordance with the agreement, for any loss, expense or damage occasioned by the use of this report. Only the Client is authorized to permit copying or distribution of this report and then only in its entirety. Any use of the Intertek name or one of its marks for the sale or advertisement of the tested material, product or service must first be approved in writing by Intertek. The observations and test results in this report are relevant only to the sample tested. This report by itself does not imply that the material, product, or service is or has ever been under an Intertek certification program."

Locks / hinges / cylinders



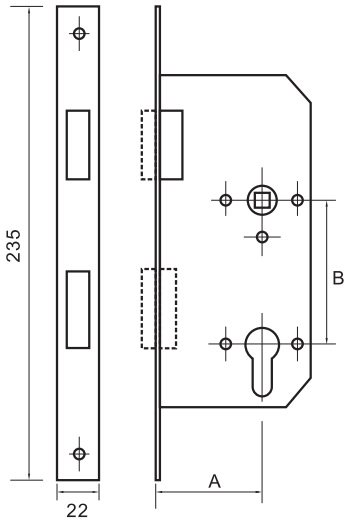
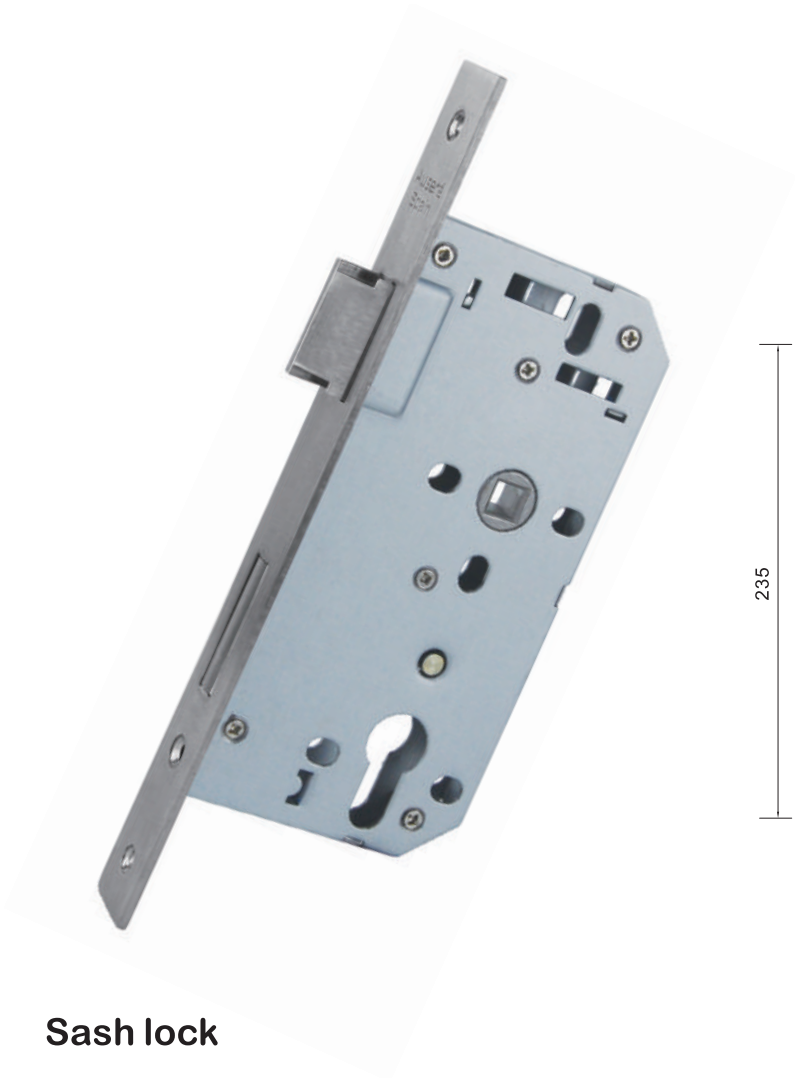

Sash lock

Front and strike plate made of stainless steel.
Latch bolt and dead bolt of stainless steel.
Steel body.
55 mm backset.
72 mm centres.
Reversible.
Lock type for cylinder.
8 mm spindle.

A backset	B centres	Item no.
60	72	10802
60	85	10803
40	85	10804
45	85	10805
50	85	10806
55	85	10807

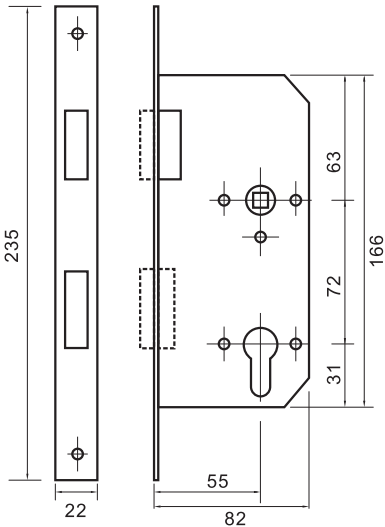

Model code 10800 Sash lock

Front and strike plate made of stainless steel.
Latch bolt and dead bolt of stainless steel.
Steel body.
55 mm backset.
72 mm centres.
Reversible.
Lock type for cylinder.
8 mm spindle.

Fire resistance: 132 minutes EN 12209:2016

3	B	8	1	0	C	1	0
---	---	---	---	---	---	---	---



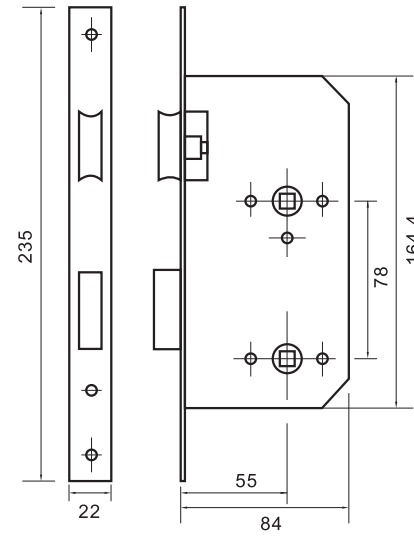

10810 WC lock

Front and strike plate made of stainless steel.
Latch bolt and dead bolt made of stainless steel.
Steel body.
55 mm backset.
78 mm centres.
Reversible.
Lock type for bathroom.
8 mm spindle for handle.
8 mm spindle for dead bolt.

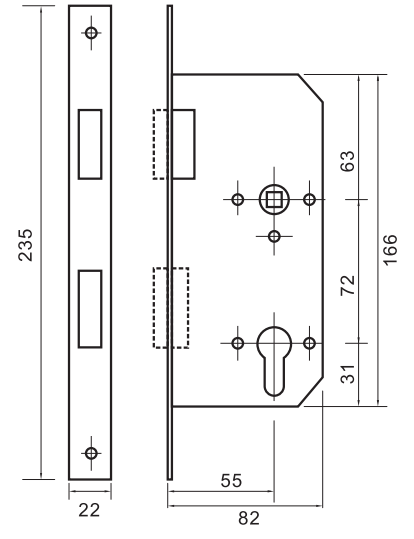

10820 Roller bolt lock

Front and strike plate made of stainless steel.
Latch bolt and dead bolt made of stainless steel.
Steel body.
55 mm backset.
72 mm centres.
Lock type for cylinder.

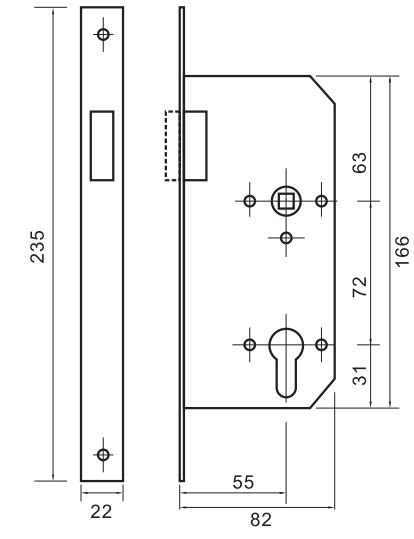

10830 Latch lock

Front and strike plate made of stainless steel.
Latch bolt made of stainless steel.
Steel body.
55 mm backset.
Reversible.
8 mm spindle for handle.

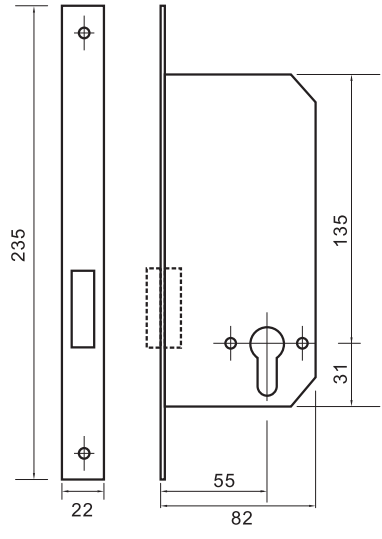

10840 Dead lock

Front and strike plate made of stainless steel.
Dead bolt made of stainless steel.
Steel body.
55 mm backset.
Reversible.
Lock type for cylinder.

Hinges
Stainless steel AISI 304 - AISI 316
Finishes: SSS - PSS - PVD

Ausere Hardware *Spain*

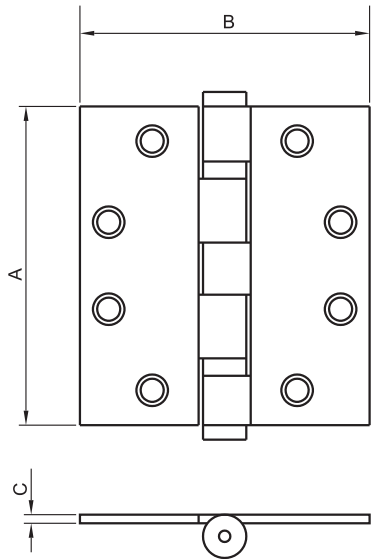
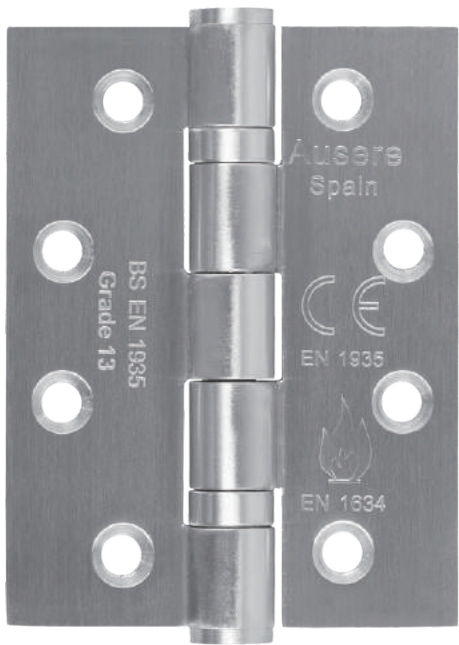

Model code 10700

Two ball bearing five knuckle hinge.
Screws for wood are included.
Can be supplied with screws for metal doors.

Manufactured according to the requirement of the standard
EN 1935:2016.
Fire resistance 132 min. 200.000 cycles.



4	7	6	1	1	4	0	13
---	---	---	---	---	---	---	----

A	B	C	Item no.
4"	3"	3mm	10700-1
4"	3,5"	3mm	10700-2
4"	4"	3mm	10700-3
4,5"	4"	3,4mm	10700-4
4,5"	4,5"	3,4mm	10700-5
5"	3"	3mm	10700-6
5"	3,5"	3mm	10700-7

Ausere Hardware *Spain*

Hinges
Stainless steel AISI 304 - AISI 316
Finishes: SSS - PSS - PVD

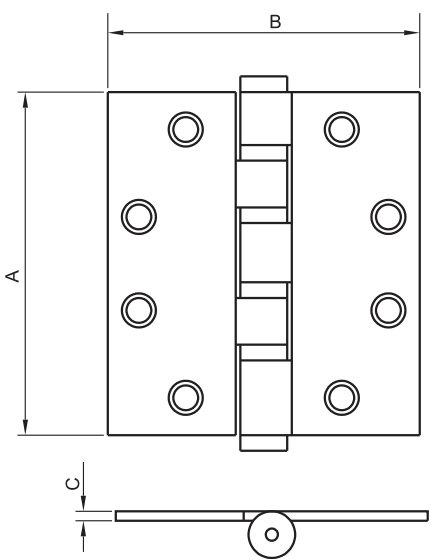
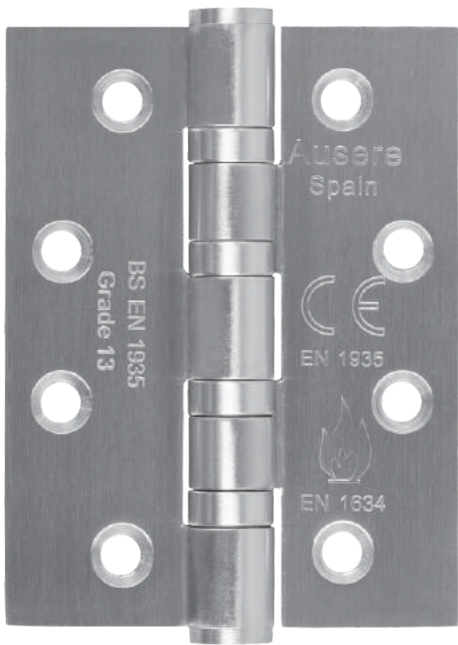

Model code 10730

Four ball bearing five knuckle hinge.
Screws for wood are included.
Can be supplied with screws for metal doors.

Manufactured according to the requirement of the standard
EN 1935:2016.
Fire resistance 132 min. 200.000 cycles.



4	7	6	1	1	4	0	13
---	---	---	---	---	---	---	----

A	B	C	Item no.
4"	3"	3mm	10730-1
4"	3,5"	3mm	10730-2
4"	4"	3mm	10730-3
4,5"	4"	3,4mm	10730-4
4,5"	4,5"	3,4mm	10730-5
5"	3"	3mm	10730-6
5"	3,5"	3mm	10730-7

Hinges

Stainless steel AISI 304 - AISI 316
Finishes: SSS - PSS - PVD

Ausere Hardware *Spain*

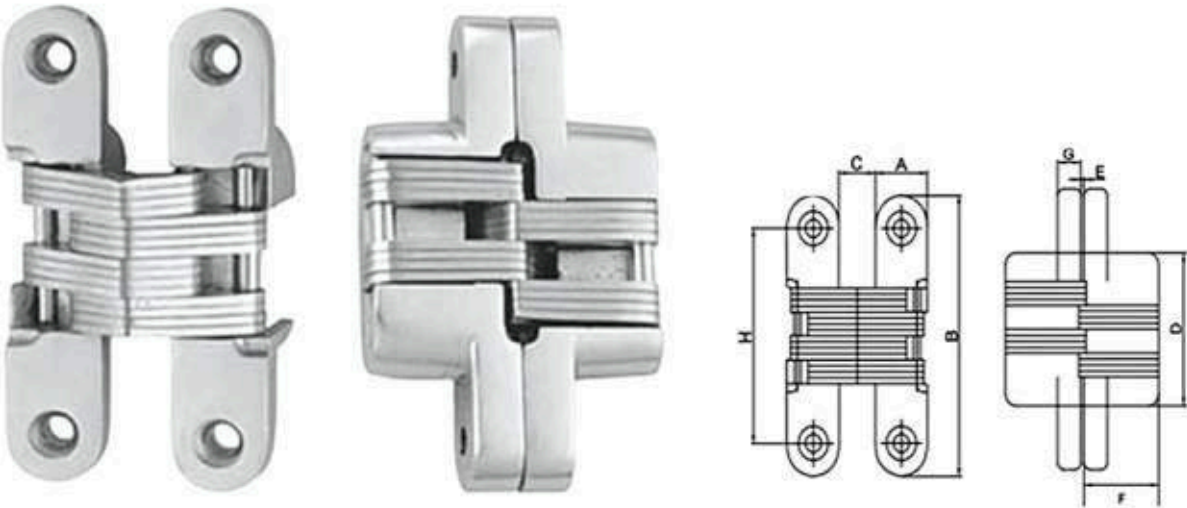

Model code 10750

Concealed.
Zink alloy body, pins made of stainless steel.
Screws for wood are included.
Can be supplied with screws for metal doors.
Non handed.

SIZE	10750-1	10750-2	10750-3	10750-4	10750-5	10750-6	10750-7	10750-8
	13x45	13x60	16x70	19x95	25x118	28x118	28x118	34x140
A	13	13	16	19	25	28	28	34
B	45	60	70	95	117,5	117,5	117,5	139,5
C	9	9	11	13	18	22	25	28
D	19	30,5	34	51,5	64	61,5	65	74,5
E	0,8	0,8	0,8	1,2	1,6	1,4	1,4	1,6
F	18	18	22,5	27	36,5	41	44	51
G	5	6	7	9	11	10	12	12
H	30,5	47	51	73	90,5	ext. 93 int. 88	90	ext. 113.5 int. 102.5
door thickness	20mm	20mm	25mm	30mm	35mm	40mm	40mm	50mm
weight per pc	55g	85g	160g	310g	650g	785g	800g	1400g
strenght per pc	5kg	10kg	15kg	25kg	30kg	40kg	25kg	50kg

Hinges

Stainless steel AISI 304 - AISI 316
Finishes: SSS - PSS - PVD

Ausere Hardware *Spain*

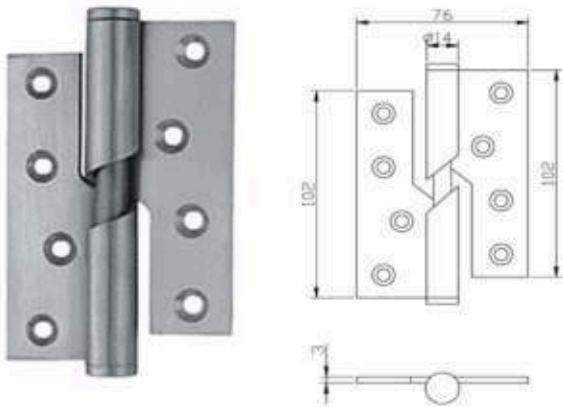

10760 Rising & falling hinge

	Item no.
Right hand rising	10760- 1
Left hand rising	10760- 2
Right hand falling	10760- 3
Left hand falling	10760- 4

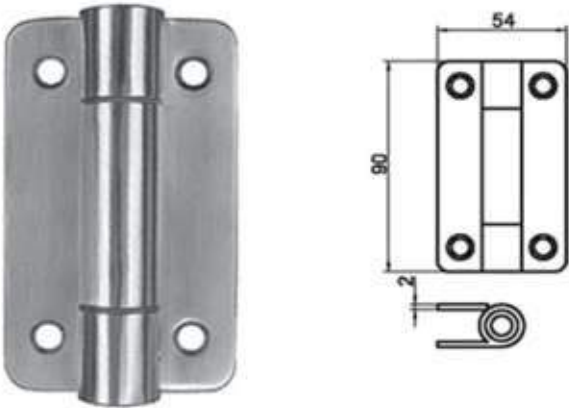

3010

Fixed hinge.
Stainless steel in AISI 304.
Screws included.

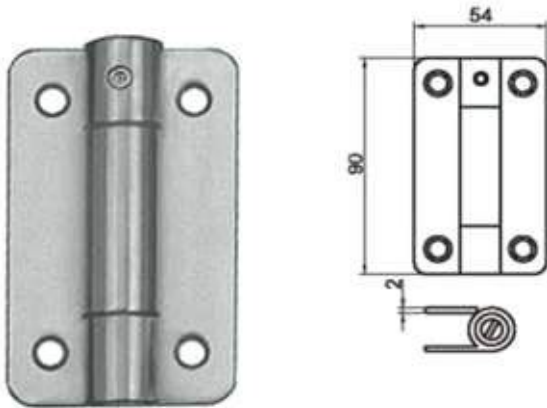

3011

Hinge with spring.
Stainless steel in AISI 304.
Screws included.



Body and interior made of brass.
6 Pins.
3 Keys.
Can be supplied with computer key.
Can be supplied with master key.

10930 (double cylinder)

Material: Brass

Size	Item no.
60 mm	10930-1 SN
60 mm	10930-1 AB
60 mm	10930-1 PB
70 mm	10930-2 SN
70 mm	10930-2 AB
70 mm	10930-2 PB
80 mm	10930-3 SN
80 mm	10930-3 AB
80 mm	10930-3 PB
90 mm	10930-4 SN
90 mm	10930-4 AB
90 mm	10930-4 PB

Finishes:

SN	Satin Niquel
AB	Antique Brass
PB	Polish Brass

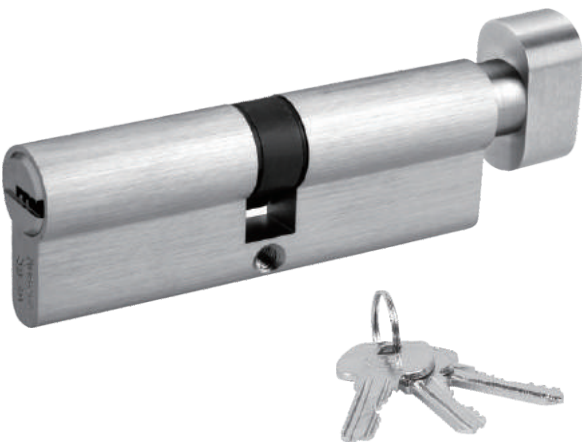

Body and interior made of brass.
6 Pins.
3 Keys.
Can be supplied with computer key.
Can be supplied with master key.

10940 (cylinder with knob/key)

Material: Brass

Size	Item no.
60 mm	10940-1 SN
60 mm	10940-1 AB
60 mm	10940-1 PB
70 mm	10940-2 SN
70 mm	10940-2 AB
70 mm	10940-2 PB
80 mm	10940-3 SN
80 mm	10940-3 AB
80 mm	10940-3 PB
90 mm	10940-4 SN
90 mm	10940-4 AB
90 mm	10940-4 PB

Finishes:

SN	Satin Niquel
AB	Antique Brass
PB	Polish Brass



10935 (single cylinder)

Material: Brass

Size	Item no.
45 mm	10935-1 SN
45 mm	10935-1 AB
45 mm	10935-1 PB

Finishes:

SN	Satin Niquel
AB	Antique Brass
PB	Polish Brass

Body and interior made of brass.
6 Pins.
3 Keys.
Can be supplied with computer key.

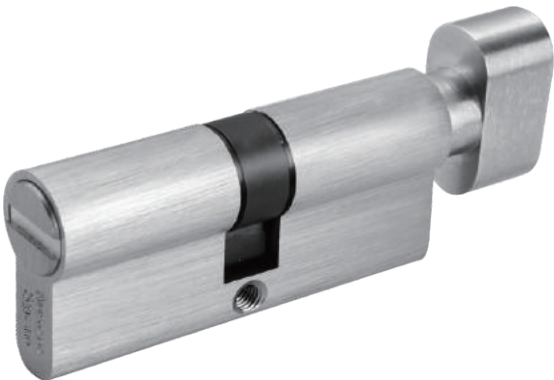

Body and interior made of brass.
6 Pins.

10950 (wc cylinder)

Material: Brass

Size	Item no.
60 mm	10950-1 SN
60 mm	10950-1 AB
60 mm	10950-1 PB
70 mm	10950-2 SN
70 mm	10950-2 AB
70 mm	10950-2 PB
80 mm	10950-3 SN
80 mm	10950-3 AB
80 mm	10950-3 PB
90 mm	10950-4 SN
90 mm	10950-4 AB
90 mm	10950-4 PB

Finishes:

SN	Satin Niquel
AB	Antique Brass
PB	Polish Brass

Model code 10915



Item no.	Technical dimensions (unit: mm)						Door closer Power Size	Recommended Door Weight	Recommended Door leaf Width (mm)
	A	B	C	D	E	F			
10915-2	147	132	19	36	56	44	SIZE 2	25-45 kg	850
10915-3	178	162-168	19	39	62	44	SIZE 3	45-65 kg	950
10915-4	204	188	19	42	71	44	SIZE 4	65-85 kg	1100
10915-5	226	208	19	46	72	44	SIZE 5	85-120 kg	1400
10915-6	248	230	19	46	72	44	SIZE 6	120-150 kg	1600

The door width given are for standard installation, in case of unusually high or heavy doors, windy or draught conditions or special installations, a large power size of door closer should be used.

Standard features

UL and CUL listed,UL10C up to 3 hours fire rating
Fixed Size 2/3/4/5/6 power size available,suit for different door weight.
Non handed for left hand and Right Hand door
High strength Die Cast aluminum body

Adjustable closing and latch Speed
All weather fluid for working temprature 55C to -42C.
Standard Reular arm and Top Jamb installation
Finish: Silver (Alumninum), Brown, White;
other finishes upon customer’s request.

Optional features
Parallel Arm Bracket for prallel arm installation

Technical features

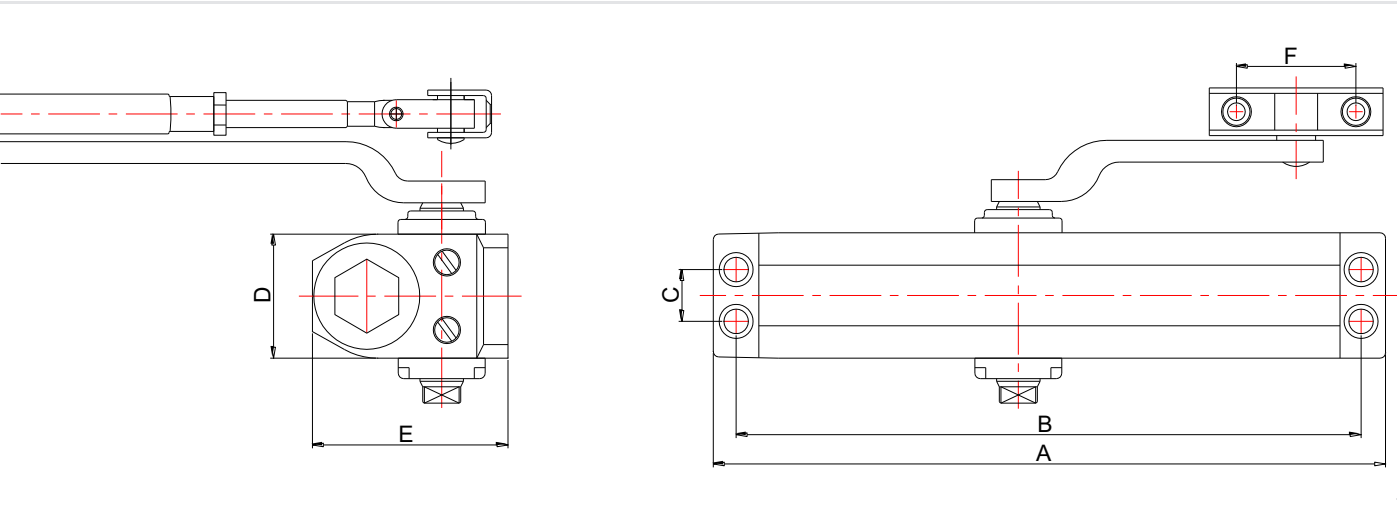

A: Closer body length
B: Horizontal Holes Spacing C: Vertical Holes Spacing
D: Closer body Width E: Closer Body Projection
F: Arm Shoe Spacing

Regular Arm installation
Closer installs on PULL/HINGE side of door

Top Jamb Installation
Closer Installs on Frame on PUSH/STOP side of door.

Parallel Arm Installation
Closer installs on PUSH/STOP side of door.



Model code 10921



STANDARD FEATURES

- UL&CUL listed, UL 10C 3 hours fire rating for Non Hold open
- Cast Aluminum body, Guide rail mounting
- Closer body inside of the door after installation.
- Fixed Closing force Size 3,Non handed for left or right hand door.
- Standard closing and latching
- Needle bearing for light opening force
- Standard packing include hold open device
- Standard and transom mounting
- Finish: silver(Aluminum); others upon the request

SELECTION CHART

Model	Closing force	Door Mass	Max Door Width	Remarks
10921	Size 3	45-65 Kg	950 mm	

TECHNICAL DIMENSIONS

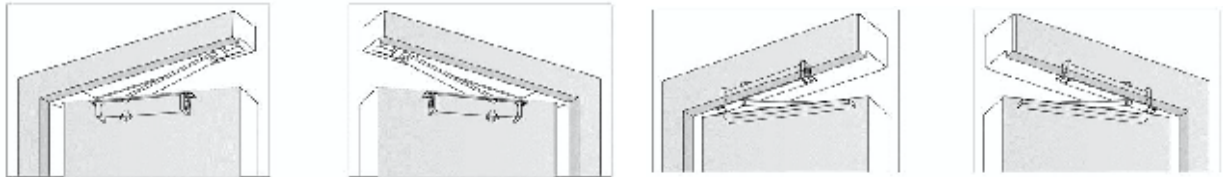
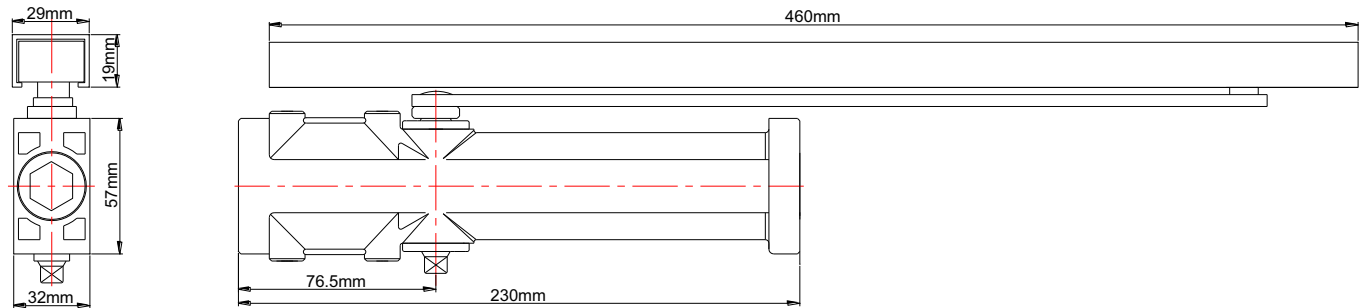

Panic device
Stainless steel AISI 304 - AISI 316
Finishes: SSS - PSS - PVD

Ausere Hardware *Spain*

Model code 10900

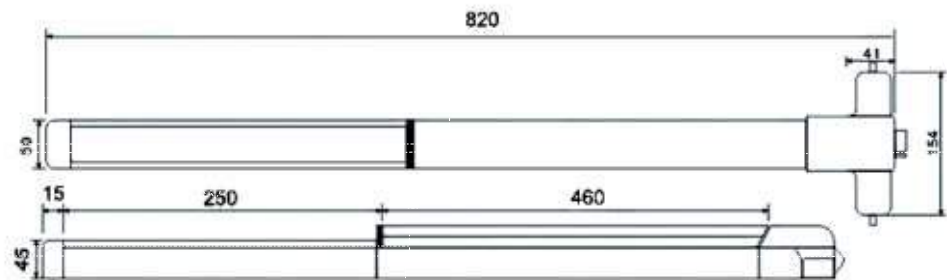

Standard features

Certificated by UL305,ANSI/BMHA A 156.3 grade 1
UL listed
None handed
Material: stainless steel
Difference finish is available

Feature	10900
Lock point	1
Touch bar	Half length of device, 500mm
Door style	Single and double door
Max. Door weight	200kg
Dogging Device	Optional
Security Anti-thrust latch	Standard
Door Width*	650-1,000mm
Door Height*	2,133mm
Door thickness*	50mm

*Note: if the door width, door height and door thickness is outside of the specification, the order should mark the special requirement.

Ausere Hardware *Spain*

Panic device
Stainless steel AISI 304 - AISI 316
Finishes: SSS - PSS - PVD

Model code 10902

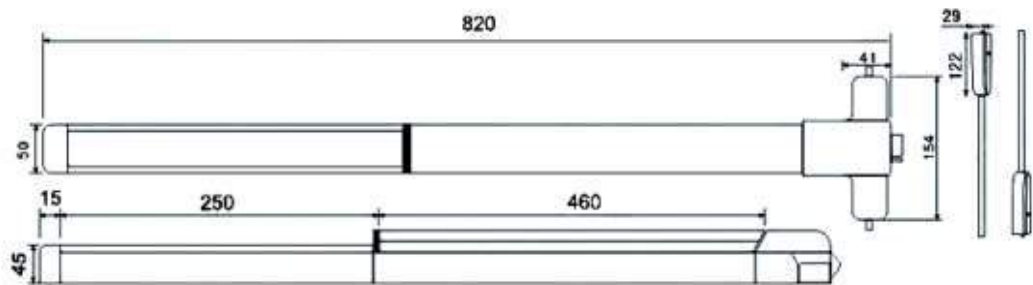

Standard features

Certificated by UL305,ANSI/BMHA A 156.3 grade 1
UL listed
None handed
Material: stainless steel
Difference finish is available

Feature	10902
Lock point	2
Touch bar	Half length of device, 500mm
Door style	Single and double door
Max. Door weight	200kg
Dogging Device	Optional
Security Anti-thrust latch	N/A
Door Width*	650-1,000mm
Door Height*	2,133mm
Door thickness*	50mm

*Note: if the door width, door height and door thickness is outside of the specification, the order should mark the special requirement.

Panic handle
Stainless steel AISI 304 - AISI 316
Finishes: SSS - PSS - PVD

Ausere Hardware *Spain*



Model code 10901



Technical features

Escutcheon lever trim
Non handed
Stainless steel AISI 304
Finishes: SSS - PSS - PVD - AB
Door thickness: 45 - 50 mm
Certificated: EN 1634 fire rates

Feature	CMP001	CMP006
Lock point	1	2
Touch bar	Half length of device, 500mm	
Door style	Single and double door	
Max. Door weight	200kg	
Dogging Device	Optional	Optional
Security Anti-thrust latch	Standard	N/A
Door Width*	650-1,000m	
Door Height*	2,133mm	
Door thickness*	50mm	

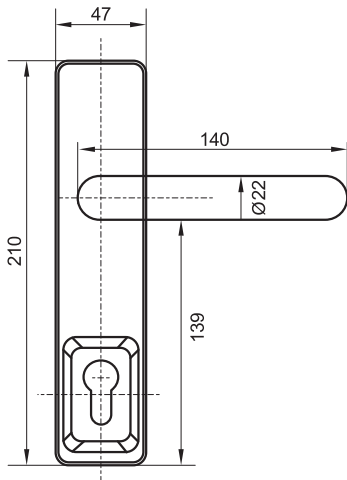

*Note: if the door width, door height and door thickness is different of the specifications of the specification, the order should mark the special requirement.

Ausere Hardware *Spain*

Accessories



Accessories
Stainless steel AISI 304 - AISI 316
Finishes: SSS - PSS - PVD

8501



A	B	C	Item no.
10	96	160	8501-1001
10	128	192	8501-1002
10	160	224	8501-1003
10	192	256	8501-1004
10	224	288	8501-1005
10	256	320	8501-1006
10	288	352	8501-1007
10	320	384	8501-1008
10	416	480	8501-1009
10	512	576	8501-1010
10	736	800	8501-1011
10	896	960	8501-1012

A	B	C	Item no.
12	96	160	8501-1201
12	128	192	8501-1202
12	160	224	8501-1203
12	192	256	8501-1204
12	224	288	8501-1205
12	256	320	8501-1206
12	288	352	8501-1207
12	320	384	8501-1208
12	416	480	8501-1209
12	512	576	8501-1210
12	736	800	8501-1211
12	896	960	8501-1212

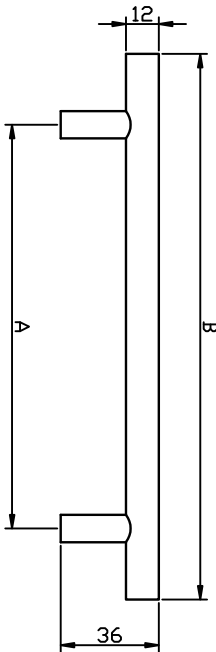

8502



A	B	Item no.
10	96 mm	8502-1
10	128 mm	8502-2
10	160 mm	8502-3
10	192 mm	8502-4
10	224 mm	8502-5
10	288 mm	8502-6
10	384 mm	8502-7
10	448 mm	8502-8

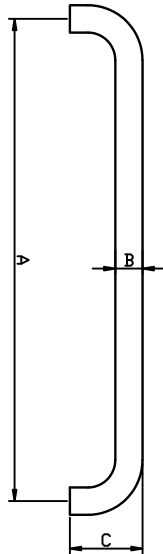

HERRAJES AUSERE - Catalog

Ausere Hardware *Spain*

Ausere Hardware *Spain*

Accessories
Stainless steel AISI 304 - AISI 316
Finishes: SSS - PSS - PVD

8503



A	item nº
96	8503-1
128	8503-2
160	8503-3
192	8503-4
224	8503-5
256	8503-6

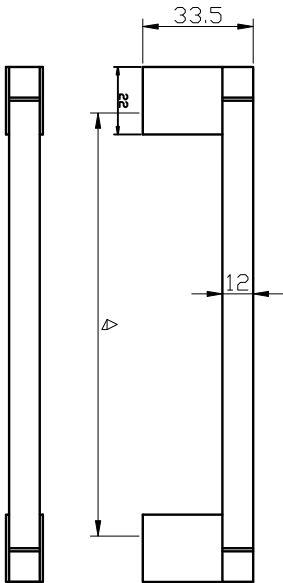

8504



A	B	Item no.
12 x 12 mm	96 mm	8504-1
12 x 12 mm	128 mm	8504-2
12 x 12 mm	160 mm	8504-3
12 x 12 mm	192 mm	8504-4
12 x 12 mm	224 mm	8504-5
15 x 15 mm	96 mm	8504-11
15 x 15 mm	128 mm	8504-12
15 x 15 mm	160 mm	8504-13
15 x 15 mm	192 mm	8504-14
15 x 15 mm	224 mm	8504-15

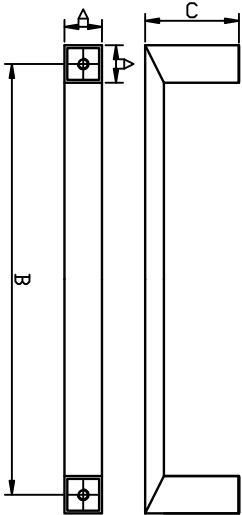

HERRAJES AUSERE - Catalog

8572



8573



8574

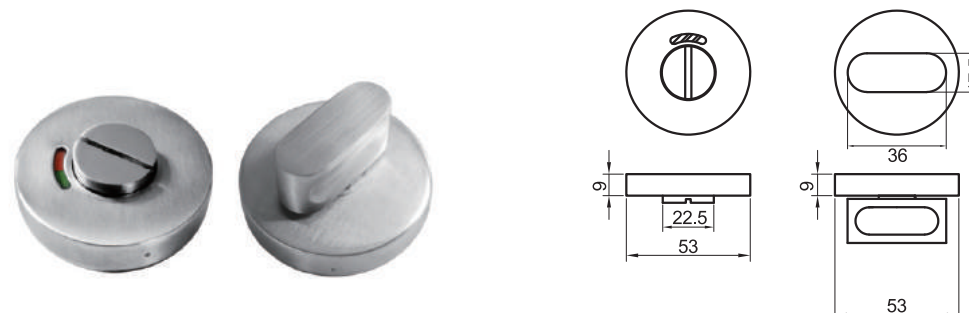

8576



8561

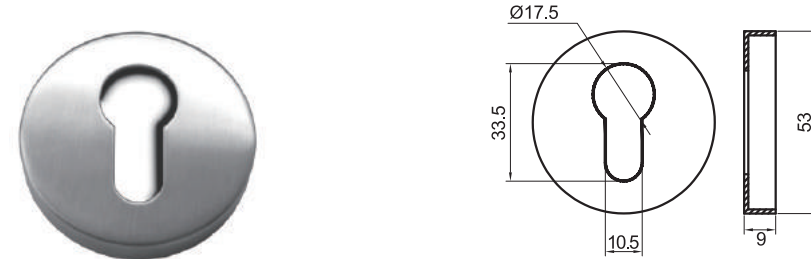

8563

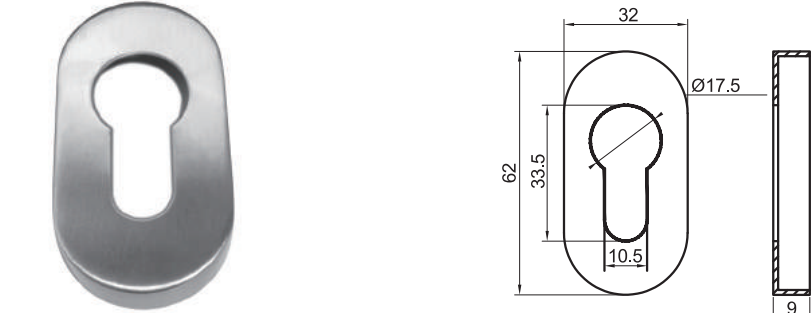

8566

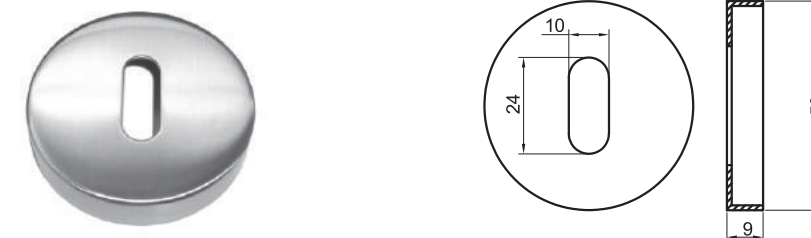

8568

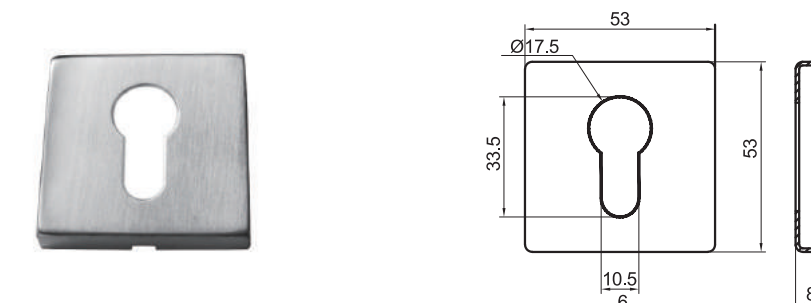

Accessories
Stainless steel AISI 304 - AISI 316
Finishes: SSS - PSS - PVD

Ausere Hardware *Spain*



8567



8569

Ausere Hardware *Spain*

Accessories
Stainless steel AISI 304 - AISI 316
Finishes: SSS - PSS - PVD



8516-20 / ø 20 mm
8516-25 / ø 25 mm



8517-15 / ø 15 mm
8517-20 / ø 20 mm



8510-20 / ø 20 mm
8510-25 / ø 25 mm



8511-15 / ø 15 mm
8511-20 / ø 20 mm
8511-25 / ø 25 mm



8540 - 20 / ø 20 mm
8540 - 25 / ø 25 mm

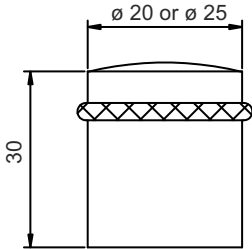

8541

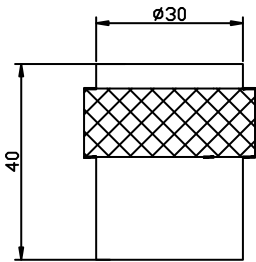

8512-25 / ø 25 mm



8513-20 / ø 20 mm
8513-25 / ø 25 mm
8513-30 / ø 30 mm



8542

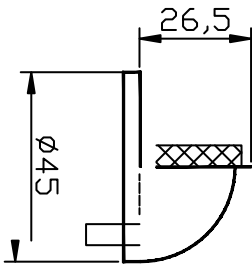

8543

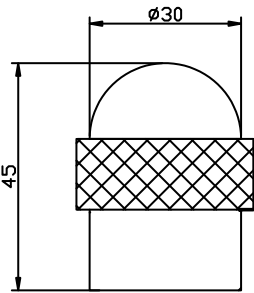

8514-10 / ø 10 mm
8514-15 / ø 15 mm
8514-20 / ø 20 mm
8514-25 / ø 25 mm



8515-20 / ø 20 mm
8515-25 / ø 25 mm



8544

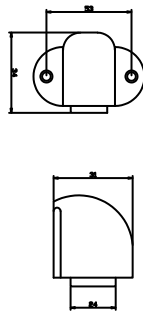

8545

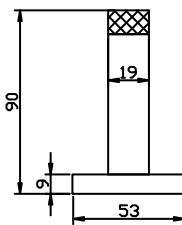

8530 lever action flush bolt



A	B	Item no.
150	25	8530-1
200	25	8530-2
250	25	8530-3
300	25	8530-4

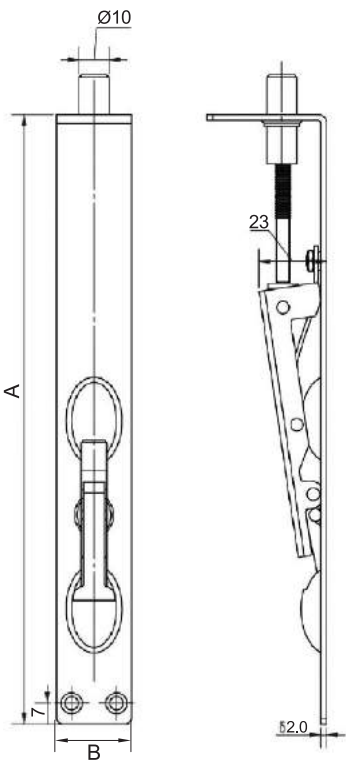

8531 lever action flush bolt



A	B	Item no.
160	17	8531-1
200	17	8531-2
255	17	8531-3
300	17	8531-4

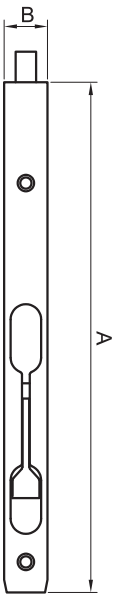

8532 Metal door flush bolt



Measure	A	Item no.
171x25	150	8532-1
171x25	200	8532-2
171x25	250	8532-3
171x25	300	8532-4

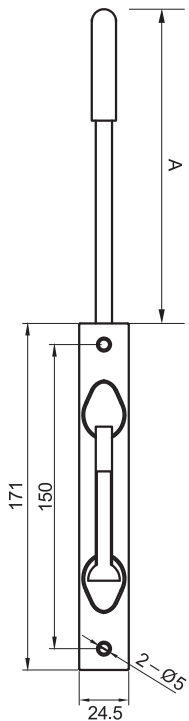

8539 Dust excluding socket

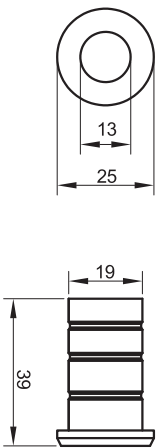

Accessories

Stainless steel AISI 304 - AISI 316
Finishes: SSS - PSS - PVD

Ausere Hardware *Spain*

8593 door viewer



8597 concealer door chain



8598 door chain



8599 door guard



Ausere Hardware *Spain*

Accessories

Stainless steel AISI 304 - AISI 316
Finishes: SSS - PSS - PVD



8580

100 x 100 mm



8581

100 x 100 mm



8582

ø 76



8583

ø 76



8584

ø 76



8585

ø 76



8586

120 mm



8587

120 mm

Herrajes Ausere

HERRAJES AUSERE SL
Calle P nave 5
Polígono Malpica-Alfindén
50171 LA PUEBLA DE ALFINDEN
ZARAGOZA
SPAIN

Phone 0034 976 10 84 93
Fax 0034 976 10 79 47

E-mail: export@ausere.com
internacional@ausere.com

www.herrajesausere.com